

INCABOX

DIN Panel Mount Enclosure

General features

Standard DIN 43700

Material self-extinguishing PPO

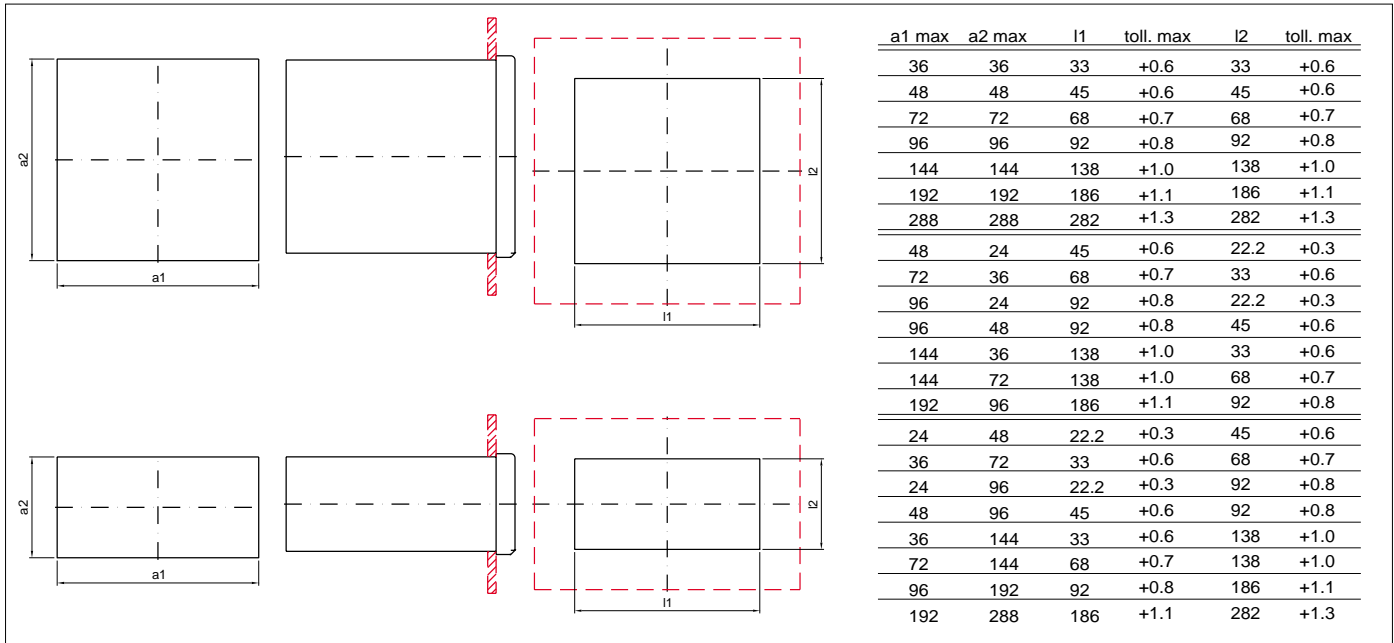

4

FEATURES	TEST METHOD	UNITS	PPO	
Mechanical test	Resistance to tensile stress at yield	ASTM D 638	MPa	40
	Tensile strength	ASTM D 638	MPa	40
	Elongation at yield	ASTM D 638	%	4
	Ultimate elongation	ASTM D 638	%	25
	Tensile modulus	ASTM D 638	MPa	2800
	Stress of flexure at yield	ASTM D 790	MPa	75
	Flexing modulus	ASTM D 790	MPa	2800
	Hardness H358/30	-	MPa	113
	Rockwell hardness	ASTM D 785	-	L93
	Taber abrasion resistance, CS-17.1 Kg	GE	-	20
Shock test	Charpy test notched	-	KJ/m ²	10
	Izod test notched	ASTM D 256	J/m	150
	Izod test notched at -40°C	ASTM D 256	J/m	75
Thermal test	Vicat softening temperature method B	ASTM D 1525	°C	105
	Vicat VST/B/120	-	°C	95
	Temp. of deformation with head of 1.8Mpa	ASTM D 648	°C	90
	Thermal conductivity	ASTM C 177	W/m°C	0,16
	Coefficient of linear thermal expansion	ASTM D 696	n/m°C	7x10 ⁻⁵
Physical test	Specific gravity	ASTM D 792	-	1,14
	Water absorption 24 h	ASTM D 570	%	0,08
	Water absorption on balance	ASTM D 570	%	0,37
	Water absorption on balance at 100°C	ASTM D 570	%	0,55
	Mould shrinkage	ASTM D 570	%	0.5-0.7
Electrical test	Specific volume resistivity	ASTM D 257	Ohm-cm	<10 ¹²
Flame test	Oxygen index	ASTM D 2863	%	31
	Self extinguisher (thickness in mm)	UL 94	-	V-0 (2.00) 5V (2.5)

The INCABOX series can be supplied with different types of material. The above listed features are those of General Electric Noryl®. Italtronic can operate any change of the materials without being obliged to forewarn.

Signaworks / Excel Controls Inc. 7445-A Montgomery Drive, Plain City, OH 43064 Phone: 614-873-0980 FAX: 614-873-0982

www.italtronicusa.com E-mail sales@italtronicusa.com

INCABOX

Panel mounting enclosures for electronic products according to DIN 43700

material: self-extinguishing PPO
colour: Black
dimensions: 36.72, 72.72, 72.144, 48.48, 48.96, 96.96, 144.144



FEATURES

INCABOX is a panel mounting enclosure for electronic products. It has been designed for use with machining equipment and can be mounted on the front panel of the electrical control system. It is designed and manufactured to DIN 43700 and its front frame is an integrated moulded part of the main body of the enclosure whereas the rear frame is inserted by a snap-lock mechanism. The front panel is the part which is seen by the user and it is inserted into the enclosure by use of a snap-lock mechanism. LCD displays and/or push button switches can be mounted on the PCB behind the front panel and can be viewed or accessed through pre-machined cut-outs. The PCB is inserted from the rear side of the enclosure using the internal PCB guides. However, type 144x144, and other versions are available where the PCB can be inserted from either the front or rear of the enclosure. INCABOX is a versatile enclosure, easy to use and ergonomic thanks to the wide range of standard dimensions, special dimensions upon request, diverse typologies of front and rear panels, possible machining and silk printing processes and the availability of IP 65 protection covers.

INCABOX

Printed circuit boards dimensions

Note: different lengths (L) may be ordered upon our technical approval.

For example: 48x96Bx80 = code 01.109080

CODICE / CODE	DIM / DIM
01.107 L057	36x72Bx57
01.107 L075	36x72Bx75
01.107 L100	36x72Bx100
01.110 L057	72x72Bx57
01.110 L075	72x72Bx75
01.110 L100	72x72Bx100
01.110 L124	72x72Bx124
01.110 L156	72x72Bx156
01.112 L057	72x144BS2x57
01.112 L075	72x144BS2x75
01.112 L100	72x144BS2x100
01.112 L114	72x144BS2x114
01.115 L124	72x144BS2x124
01.115 L139	72x144BS2x139
01.116 L200	72x144BS2x200
01.120 L057	48x48Bx57
01.120 L075	48x48Bx75
01.120 L100	48x48Bx100
01.120 L124	48x48Bx124
01.120 L156	48x48Bx156
01.108 L057	48x48Mx57
01.108 L075	48x48Mx75
01.108 L100	48x48Mx100
01.108 L124	48x48Mx124
01.108 L156	48x48Mx156
01.109 L057	48x96Bx57
01.109 L075	48x96Bx75
01.109 L100	48x96Bx100
01.109 L114	48x96Bx114
01.109 L124	48x96Bx124
01.113 L057	48x96Mx57
01.113 L075	48x96Mx75
01.113 L100	48x96Mx100
01.113 L114	48x96Mx114
01.113 L124	48x96Mx124
01.113 L179	48x96Mx179
01.111 L057	96x96Bx57
01.111 L075	96x96Bx75
01.111 L100	96x96Bx100
01.111 L124	96x96Bx124
01.114 L057	96x96MS2x57
01.114 L075	96x96MS2x75
01.114 L100	96x96MS2x100
01.114 L124	96x96MS2x124
01.114 L179	96x96MS2x179
01.509 L057	144x144MS2x57
01.509 L075	144x144MS2x75
01.509 L100	144x144MS2x100
01.509 L114	144x144MS2x114
01.509 L139	144x144MS2x139
01.509 L156	144x144MS2x156
02.108 L069	48x48Ex69
02.108 L083	48x48Ex83
02.108 L109	48x48Ex109
02.502 L057	48x96Ex57
02.502 L075	48x96Ex75
02.502 L100	48x96Ex100
02.502 L124	48x96Ex124
02.502 L179	48x96Ex179

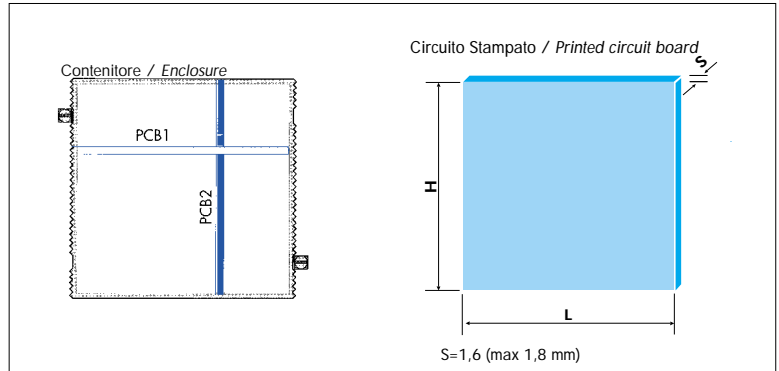

ENCLOSURE	H PCB		L PCB															
	PCB 1	PCB 2	L57	L69	L75	L83	L100	L109	L114	L124	L139	L156	L179	L200				
36.72B	62																	
72.72B	59,5																	
72.144BS2	129,5	61,5																
48.48B	39																	
48.48M	39																	
48.96B	84,5																	
48.96M	84,5																	
96.96B	81,6																	
96.96MS2	81,5	84,5																
144.144MS2	129,5	129,5																
48.48E																		
48.96E																		

INCABOX Dimensioni dei pannelli / Panel dimensions

Front panel

Tolerances

- (1) ALLUMINIO ALUMINIUM L = ±0.2 H = ±0.2 S = ±0.05
- (2) PLEXIGLASS PLEXIGLASS L = ±0.2 H = ±0.2 S = ±20%
- (3) PPO L = ±0.1 H = ±0.1 S = ±0.1
- (4) PC INFRAROSSO INFRARED PC L = ±0.1 H = ±0.1 S = ±0.1

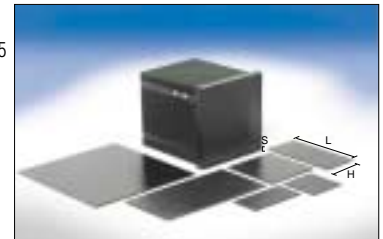

SIZE	PANEL	ALUMINIUM (1)	PLEXIGLASS (2)	PPO (3)	INFRARED PC (4)	PVC (5)
36.72	ANTERIORE / FRONT LxHxS	67.7X31.6X1.5	67.7X31.6X2.0	67.8X31.7X2.0	67.8X31.8X2.0	
72.72	ANTERIORE / FRONT LxHxS	67.5X67.5X1.5	67.5X67.5X2.0	67.6X67.6X2.0	67.6X67.6X2.0	
72.144	ANTERIORE / FRONT LxHxS	139.2X67.3X1.5	139.2X67.3X2.0	139.3X67.5X2.0	139.2X67.4X2.0	
48.48	ANTERIORE / FRONT LxHxS	43.6X43.6X1.5	43.6X43.6X2.0	43.7X43.7X2.0	43.7X43.7X2.0	
48.96	ANTERIORE / FRONT LxHxS	91.5X43.4X1.5	91.5X43.4X2.0	91.6X43.5X2.0	91.6X43.5X2.0	
96.96	ANTERIORE / FRONT LxHxS	90.6X90.6X1.5	90.6X90.6X2.0	90.7X90.7X2.2	90.7X90.7X2.2	
144.144	ANT. C/FORNI / FRONT WITH HOLES	138.0X138.0X2.0	138.0X138.0X2.0		138X138X2.0	
144.144	ANT. S/FORNI / FRONT WITHOUT HOLES		138.0X138.0X3.0			

Rear panel

Tolerances

- (1) ALLUMINIO ALUMINIUM L = ±0.2 H = ±0.2 S = ±0.05
- (3) PPO L = ±0.1 H = ±0.1 S = ±0.1
- (5) PVC L = ±0.2 H = ±0.2 S = ±20%

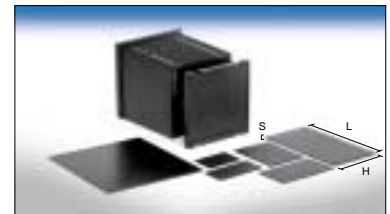

CONT. ENCL.	PANNELLO PANEL	ALUMINIUM (1)	PLEXIGLASS (2)	PPO (3)	PC INFRAROSSO INFRARED PC (4)	PVC (5)
36.72	POSTERIORE / REAR LxHxS	57.6X28.6X1.0		57.6X28.7X1.5		57.6X28.6X1.5
72.72	POSTERIORE / REAR LxHxS	63.7X49.1X1.0		63.8X49.2X1.7		63.7X49.1X1.5
72.144	POSTERIORE / REAR LxHxS	118.9X62.6X1.0		118.7X62.7X2.0		118.9X62.6X1.5
48.48	POSTERIORE / REAR LxHxS	42.2X29.6X1.0		42.3X29.6X1.8		42.2X29.6X1.5
48.96	POSTERIORE / REAR LxHxS	73.5X39.6X1.0		73.6X39.7X1.7		73.5X39.6X1.5
96.96	POSTERIORE / REAR LxHxS	86.7X71.7X1.5		86.8X71.8X1.7		86.7X71.7X1.5
144.144	POSTERIORE / REAR LxHxS	131.3X118.6X1.5				131.3X118.6X1.5

INCABOX

Panel mounting enclosures for electronic products according to DIN 43700

material: self-extinguishing PPO
colour: Black
dimensions: 36.72, 72.72, 72.144, 48.48, 48.96, 96.96, 144.144
Special lengths upon request (L)



- 1 - Corpo contenitore
- 2 - Cornice posteriore a scatto
- 3 - Pannello frontale
- 4 - Pannello posteriore
- 5 - Aggancio
- 6 - Protezione
- 7 - Aggancio per guida DIN
- 8 - Pannello UNDECAL
- 9 - Pannello OCTAL

- 1 - Body enclosure
- 2 - Rear frame with snap-lock mechanism
- 3 - Front panel
- 4 - Rear panel
- 5 - Fastening element
- 6 - Protection cover
- 7 - DIN rail fastening base
- 8 - 11 PIN rear panel (UNDECAL)
- 9 - 8 PIN rear panel (OCTAL)

* Front frame for INCABOX 144.144 only

PANELS

The following panels are available:
ALUMINIUM panels for a stronger mechanical resistance
PLEXIGLASS panels, in transparent neutral or red transparent for LCD displays to minimize the costs of mechanical processing
POLYCARBONATE panels, red colour for PC-infrared rays
PPO panels for standard application

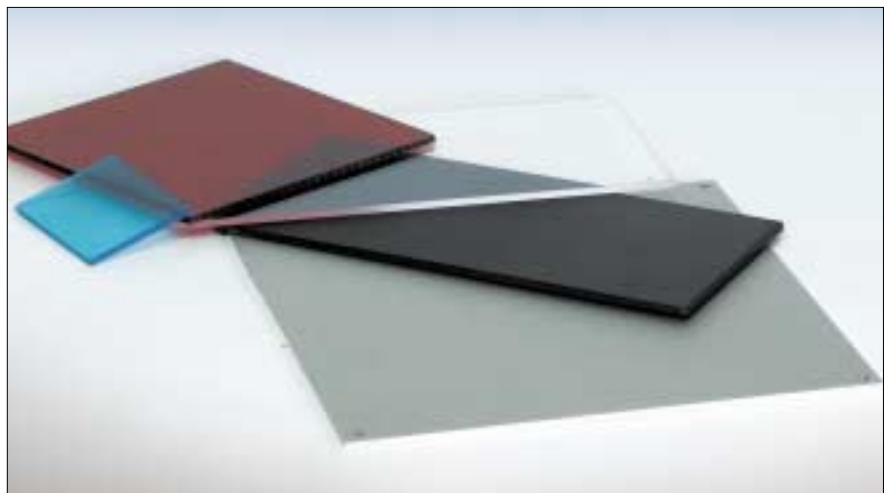

MACHINING PROCESSES

Italtronic is able to supply front and rear panels machined upon customers' request.
For any further information contact our sales department.

General features

Assembly method

ASSEMBLY METHOD

The panel mounting INCABOX enclosure, according to DIN 43700, can be easily assembled thanks to its snap-lock mechanism. No need to use any fixing elements.

All the INCABOX components (front panel, rear panel and fastening elements) are made of plastic material (metal fastening elements are also available) and this enables the insulation of the internal circuits.

The enclosure is kept in the correct position on the panel by the fastening elements after the enclosure is assembled.



*ATTENZIONE:

Il montaggio della cornice anteriore è presente solo nel modello INCABOX 144.144.

* PLEASE NOTE:

The assembly of the front frame is in the INCABOX 144.144 enclosure only.



Assemble the rear panel



Fix the printed circuit board by settling the rear frame



Insert the enclosure in the wall/panel



Use the fastening elements to fix the enclosure to the wall.

General features

Assembly method

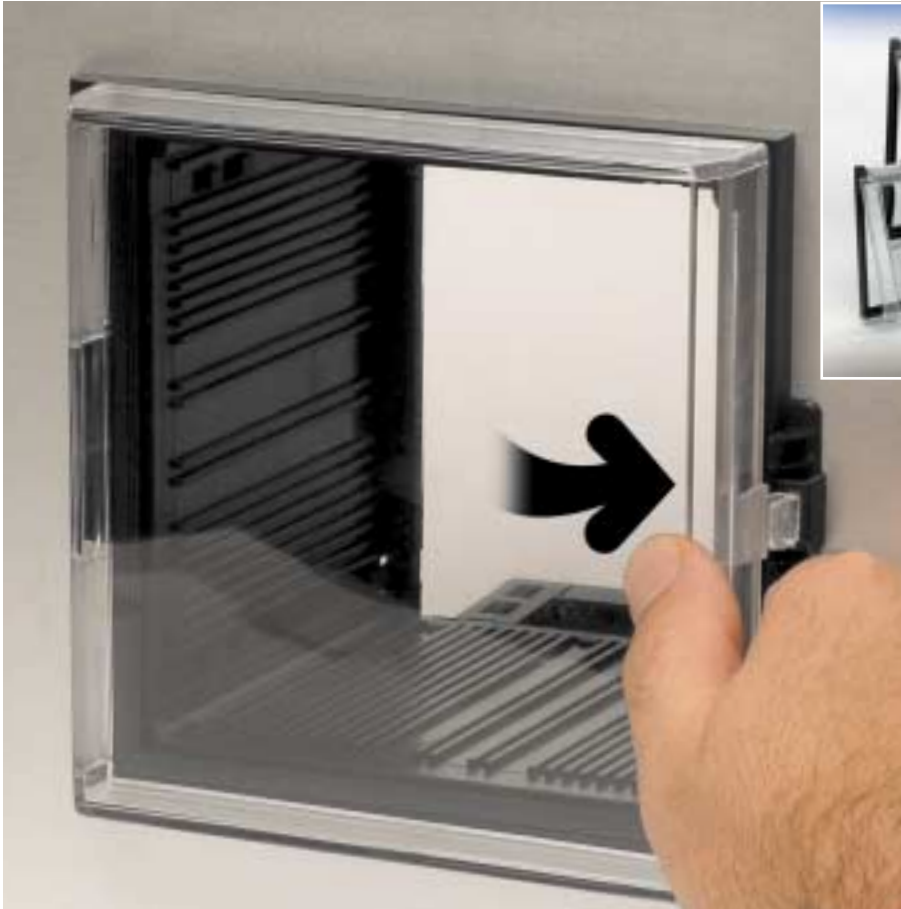

PROTECTION COVERS

INCABOX protection covers protect the electronics from dust, water and eventual damage. There are different IP protection degrees. The cover in transparent polycarbonate material allows a clear vision of the enclosed device. In case of applications requesting a higher protection degree of the electronics from water, it is advisable use protection covers together with INCABOX XT enclosure (see at page 41).



* The protection covers may be supplied, upon request, with the sealing already fitted to enable an IP65 protection degree.

INCABOX

Panel mounting enclosures for electronic products according to DIN 43700

material: Self-extinguishing PPO
 colour: Black
 dimensions: 36x72x57/75/100

CARATTERISTICHE

Contenitore a montaggio rapido senza viti.
 La scheda elettronica si inserisce dalla parte posteriore nelle apposite guide fino alla battuta interna predisposta e viene bloccata dalla cornice posteriore con ritenuta a scatto tramite due ganci.
 I pannelli anteriori e posteriori sono ad inserimento rapido a scatto.
 Disponibili su richiesta misure (L) diverse dagli standard.

FEATURES

This enclosure can easily be assembled without the use of fixing screws. The PCB is inserted from the rear side of the enclosure using the internal PCB guides and it is fixed by the rear frame with a snap-lock mechanism. Either the front or the rear panels can be inserted into the enclosure by a snap-lock mechanism.
 Lengths (L) different from the standard ones are available upon request.

36.72



36.72B

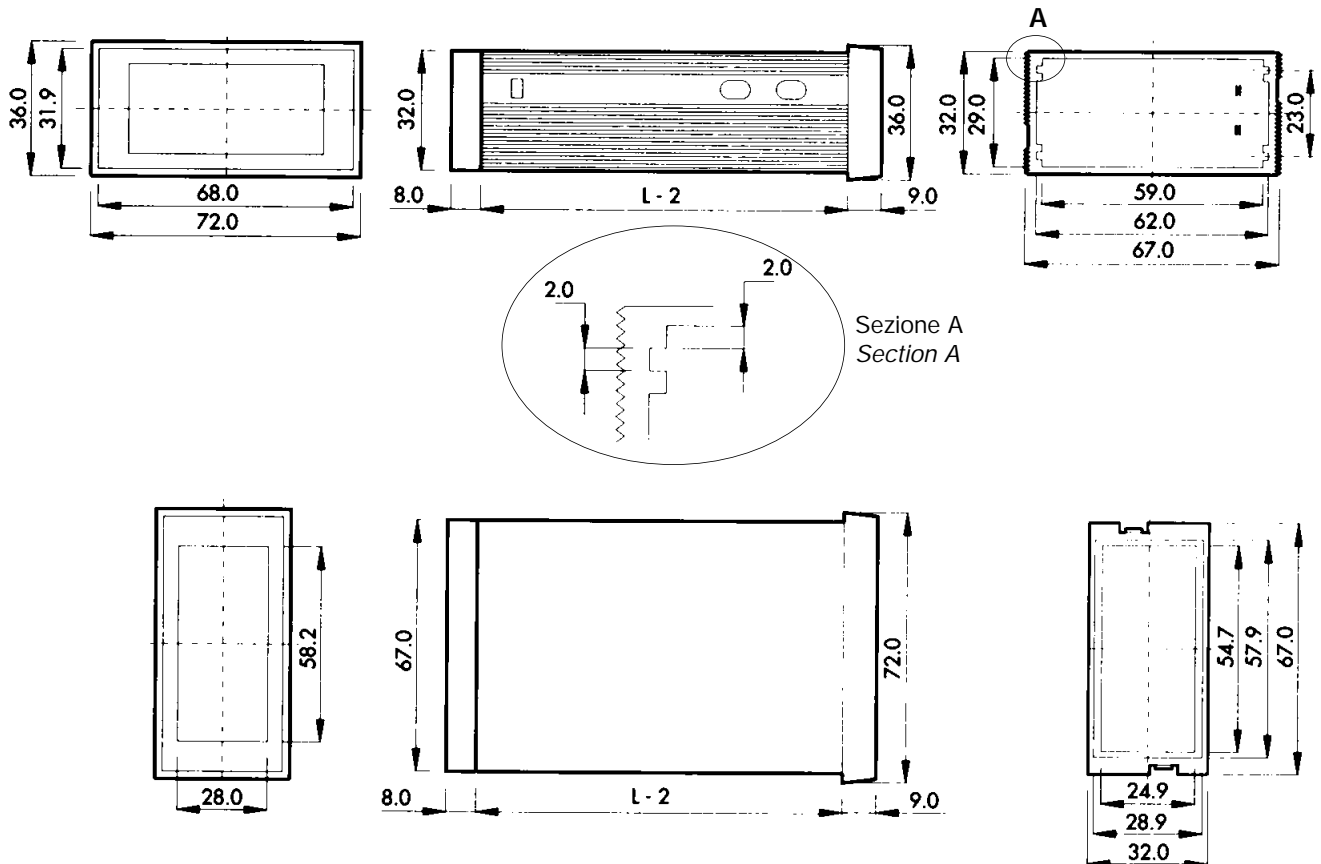

It indicates the product with the minimum number of internal guides

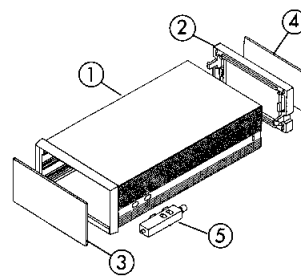
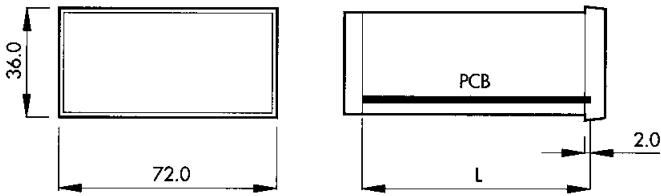

Descrizione / Description:

- 1) Corpo contenitore / Body enclosure
- 2) Cornice posteriore / Rear frame
- 3) Pannello frontale* / Front panel*
- 4) Pannello posteriore* / Rear panel*
- 5) Aggancio / Fastening element

* Accessori separati / Separate accessories

Complete Enclosure

CODICE / CODE	DESCRIZIONE / DESCRIPTION	36.72B
01.107 L057	Contenitore completo/ Complete enclosure	L 57 mm
01.107 L075	Contenitore completo/ Complete enclosure	L 75 mm
01.107 L100	Contenitore completo/ Complete enclosure	L 100 mm
01.107 LXXX	Contenitore completo/ Complet enclosure	L 80 mm max

Composizione Kit: 1 corpo contenitore, 1 cornice posteriore a scatto, 2 agganci / Kit composition: 1 body enclosure, 1 rear frame with snap-lock mechanism, 2 plastic fastening elements

Il contenitore può essere fornito con misure (L) diverse dalle predefinite fino ad un massimo di 80 mm / Special lengths (L) can be supplied upon request up to 80 mm max

Accessories

CODICE / CODE	DESCRIZIONE / DESCRIPTION	DIMENSIONI / DIMENSIONS (LxHxS)
06.291 0000	Pannello frontale, Alluminio, anodizzato opaco / Front panel, anodized, aluminium, mat	67,7x31,6x1,5
06.251 0000	Pannello frontale, PPO UL 94 V-0, nero / Front panel, PPO UL94 V-0, black	67,8x31,7x2,0
06.350 0000	Pannello frontale, Plexiglass, trasparente / Front panel, Plexiglass, transparent	67,7x31,6x2,0
06.200 0000	Pannello frontale, Plexiglass rosso, trasparente / Front panel, Plexiglass red, transparent	67,7x31,6x2,0
06.340 0000	Pannello frontale, PC per raggi infrarossi / Front panel, PC permeable to infra - red light	67,8x31,8x2,0
06.310 0000	Pannello posteriore, Alluminio, anodizzato opaco / Rear panel, anodized Aluminium, mat	57,6x28,6x1,0
06.271 0000	Pannello posteriore, PPO UL 94 V-0, nero / Rear panel, PPO UL 94 V-0, black	57,6x28,7x1,5
06.370 0000	Pannello posteriore, PVC UL 94 V-0, nero / Rear panel, PVC UL 94 V-0, black	57,6x28,6x1,5

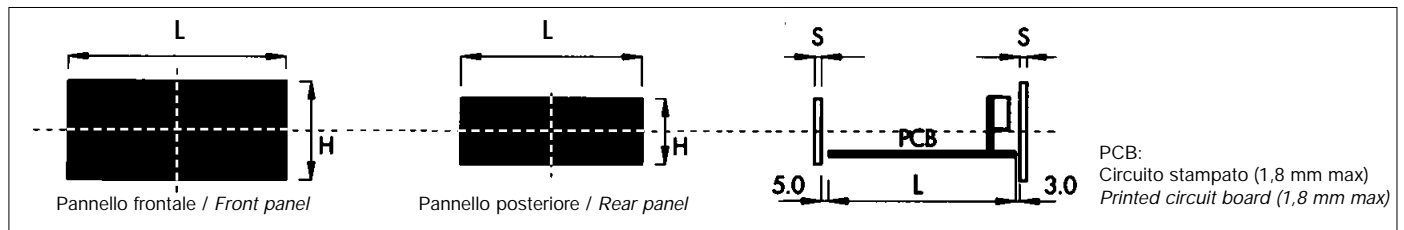

06.361 0000	Pannello posteriore, OCTAL con pins montati / 8 PIN rear panel with mounted pins (OCTAL)	57,6x28,8x1,5
06.366 0000	Pannello posteriore, UNDECAL con pins montati / 11 PIN rear panel with mounted pins (UNDECAL)	57,6x28,8x1,5

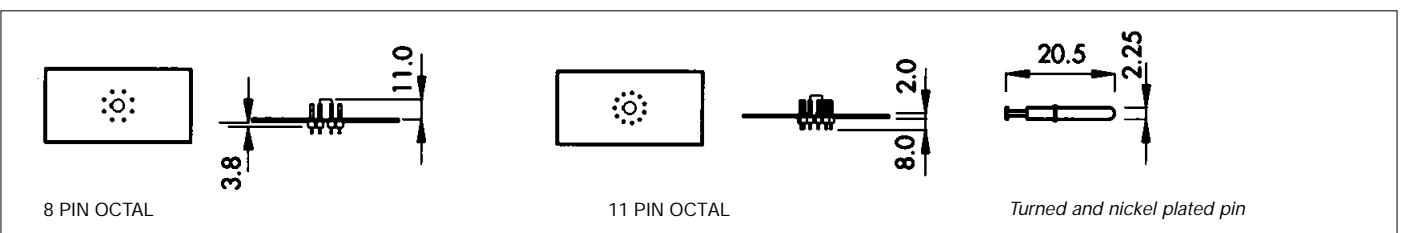

INCABOX

Panel mounting enclosures for electronic products according to DIN 43700

material: Self-extinguishing PPO
 colour: Black
 dimensions: 72x72x57/75/100/124/156

FEATURES

This enclosure can easily be assembled without the use of fixing screws. The PCB is inserted from the rear side of the enclosure using the internal PCB guides and it is fixed by the rear frame with a snap-lock mechanism. Either the front or the rear panels can be inserted into the enclosure by a snap-lock mechanism. Lengths (L) different from the standard ones are available upon request.

72.72



72.72B

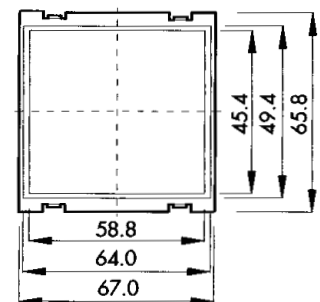
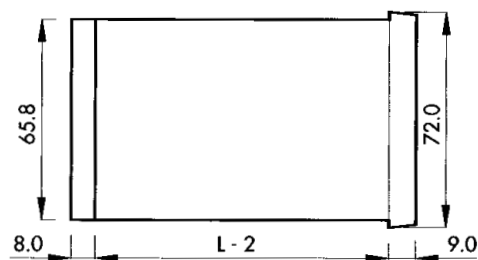
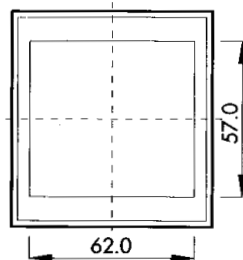
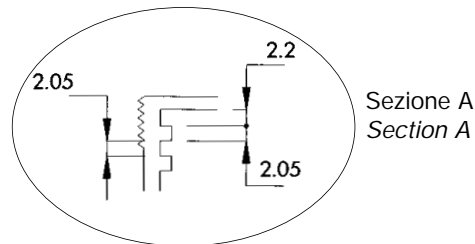
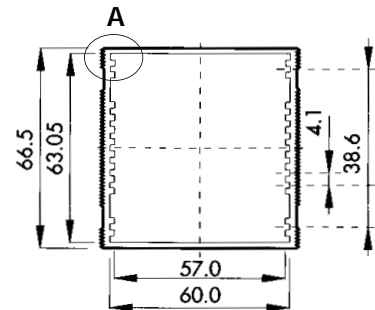
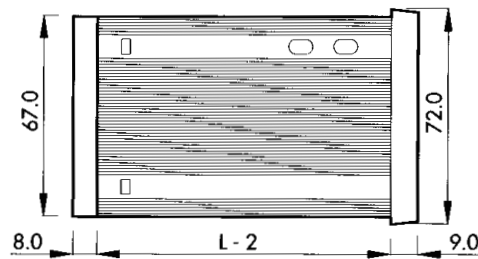
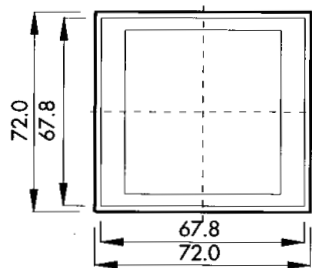

It indicates the product with the minimum number of internal guides

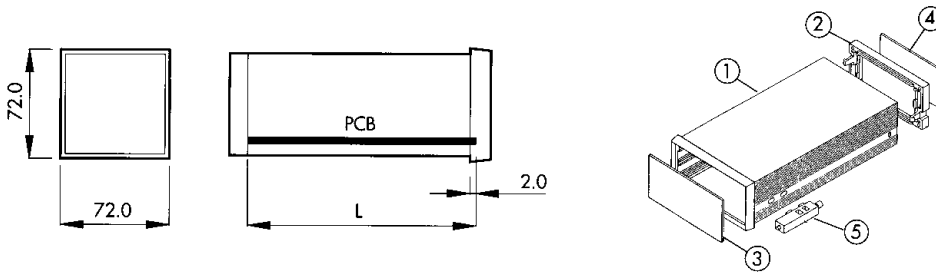

Descrizione / Description:

- 1) Corpo contenitore / *Body enclosure*
- 2) Cornice posteriore / *Rear frame*
- 3) Pannello frontale* / *Front panel**
- 4) Pannello posteriore* / *Rear panel**
- 5) Aggancio / *Fastening element*

* Accessori separati / *Separate accessories*

Complete Enclosure

CODICE / CODE	DESCRIZIONE / DESCRIPTION	72.72B
01.110 L057	Contenitore completo / <i>Complete enclosure</i>	L 57 mm
01.110 L075	Contenitore completo / <i>Complete enclosure</i>	L 75 mm
01.110 L100	Contenitore completo / <i>Complete enclosure</i>	L 100 mm
01.110 L124	Contenitore completo / <i>Complete enclosure</i>	L 124 mm
01.110 LXXX	Contenitore completo / <i>Complete enclosure</i>	L 136 mm max
LUNGHEZZE OTTIMIZZATE / <i>SPECIAL LENGTHS</i>		
01.110 L156	Contenitore completo / <i>Complete enclosure</i>	L 156 mm

Composizione kit: 1 corpo contenitore, 1 cornice posteriore a scatto, 2 agganci / *Kit composition: 1 body enclosure, 1 rear frame with snap-lock mechanism, 2 plastic fastening elements.*

Il contenitore può essere fornito con misure (L) diverse dalle predefinite fino ad un massimo di 136 mm / *Special lengths (L) can be supplied upon request to a maximum of 136 mm.*

Accessories

CODICE / CODE	DESCRIZIONE / DESCRIPTION	DIMENSIONI / DIMENSIONS (LxHxS)
06.294 0000	Pannello frontale, Alluminio, anodizzato opaco / <i>Front panel, anodized aluminium, mat</i>	67,5x67,5x1,5
06.254 0000	Pannello frontale, PPO UL 94 V-0, nero / <i>Front panel, PPO UL 94 V-0, black</i>	67,5x67,5x2,0
06.353 0000	Pannello frontale, Plexiglass, trasparente / <i>Front panel, Plexiglass, transparent</i>	67,5x67,5x2,0
06.203 0000	Pannello frontale, Plexiglass rosso, trasparente / <i>Front panel, red Plexiglass, transparent</i>	67,5x67,5x2,0
06.343 0000	Pannello frontale, PC per raggi infrarossi / <i>Front panel, PC for infra-red rays</i>	67,5x67,5x2,0
06.313 0000	Pannello posteriore, Alluminio, anodizzato opaco / <i>Rear panel, anodized aluminium, mat</i>	63,7x49,1x1,0
06.274 0000	Pannello posteriore, PPO UL 94 V-0, nero / <i>Rear panel, PPO UL 94 V-0, black</i>	63,8x49,2x1,7
06.373 0000	Pannello posteriore, PVC UL 94 V-0, nero / <i>Rear panel, PVC UL 94 V-0, black</i>	63,7x49,1x1,5

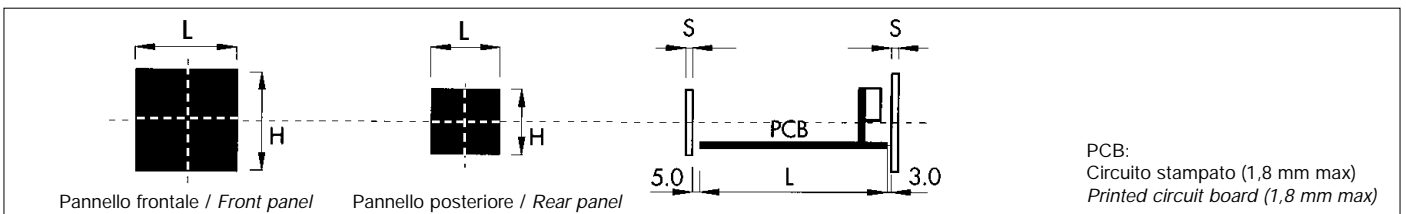

06.365 0000	Pannello posteriore, OCTAL con pins montati / <i>8 PIN rear panel with mounted pins (OCTAL)</i>	63,9x49,3x1,8
06.369 0000	Pannello posteriore, UNDECAL con pins montati / <i>11 PIN rear panel with mounted pins (UNDECAL)</i>	63,9x49,3x1,8

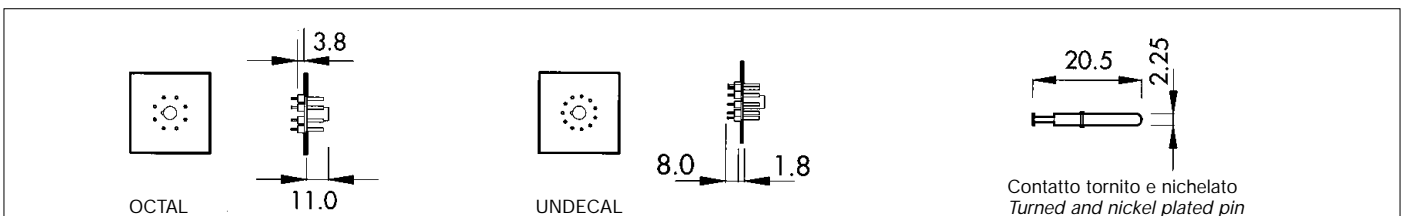

03.433 0000	Protezione IP54 / <i>Protection cover IP54</i>
03.443 0000	Protezione IP65 / <i>Protection cover IP65</i>

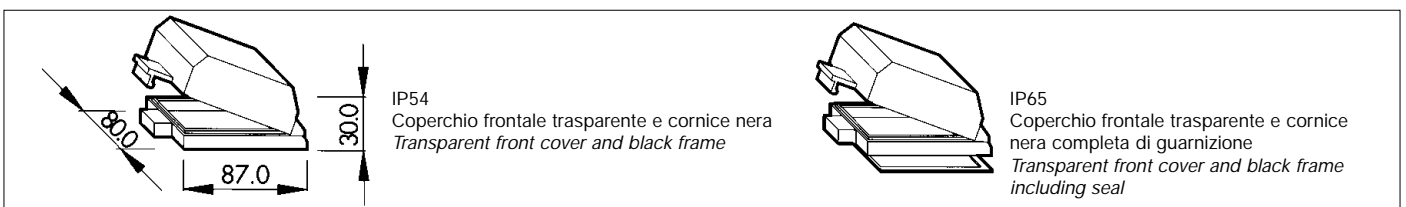

INCABOX

Panel mounting enclosures for electronic products according to DIN 43700

material: Self-extinguishing PPO
 colour: Black
 dimensions: 72x144x57/75/100/114/124/139/200

CARATTERISTICHE

Contenitore a montaggio rapido senza viti.
 La scheda elettronica si inserisce dalla parte posteriore nelle apposite guide fino alla battuta interna predisposta e viene bloccata dalla cornice posteriore con ritenuta a scatto tramite due ganci.
 I pannelli anteriori e posteriori sono ad inserimento rapido a scatto.
 Disponibili su richiesta misure (L) diverse dagli standard.

FEATURES

This enclosure can easily be assembled without the use of fixing screws. The PCB is inserted from the rear side of the enclosure using the internal PCB guides and it is fixed by the rear frame with a snap-lock mechanism. Either the front or the rear panels can be inserted into the enclosure by a snap-lock mechanism.

Lengths (L) different from the standard ones are available upon request.

72.144



BS2

72.144 BS2

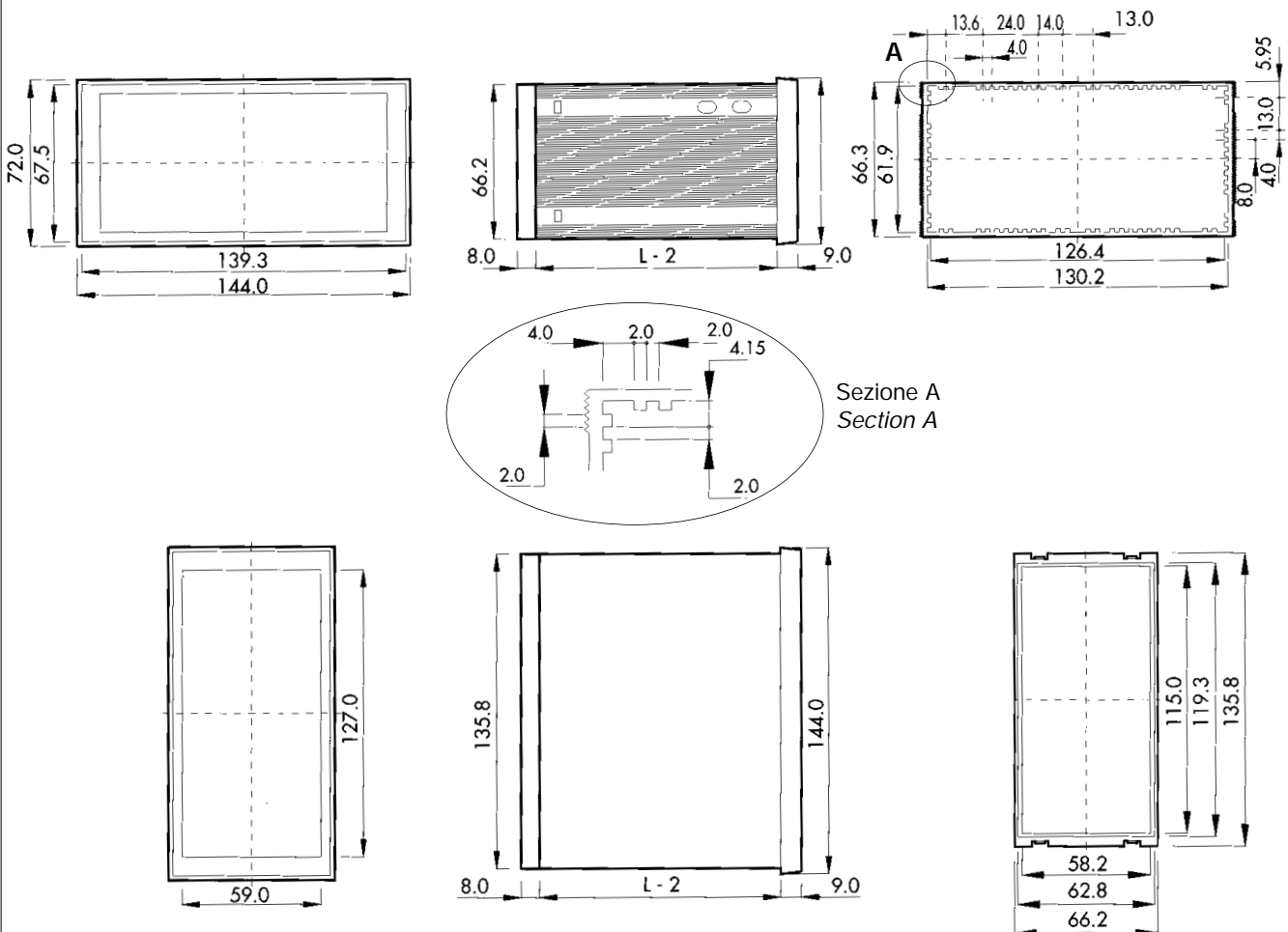

It indicates the product with the minimum number of internal guides
 It indicates the possibility to assemble the PCBs on both sides of the enclosure

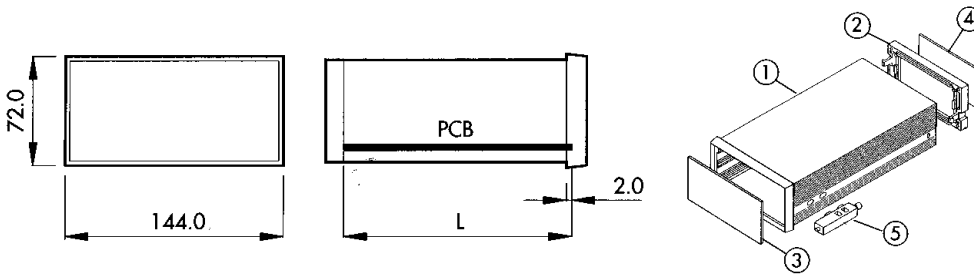

Descrizione / Description:

- 1) Corpo contenitore / *Body enclosure*
- 2) Cornice posteriore / *Rear frame*
- 3) Pannello frontale* / *Front panel**
- 4) Pannello posteriore* / *Rear panel**
- 5) Aggancio / *Fastening element*

* Accessori separati / *Separate accessories*

Complete Enclosure

CODICE / CODE	DESCRIZIONE / DESCRIPTION	72.144BS2
01.112 L057	Contenitore completo / <i>Complete enclosure</i>	L 57 mm
01.112 L075	Contenitore completo / <i>Complete enclosure</i>	L 75 mm
01.112 L100	Contenitore completo / <i>Complete enclosure</i>	L 100 mm
01.115 L124	Contenitore completo / <i>Complete enclosure</i>	L 124 mm
01.116 LXXX	Contenitore completo / <i>Complete enclosure</i>	L 180 mm max
SPECIAL LENGTHS		
01.112 L114	Contenitore completo / <i>Complete enclosure</i>	L 114 mm
01.115 L139	Contenitore completo / <i>Complete enclosure</i>	L 139 mm
01.116 L200	Contenitore completo / <i>Complete enclosure</i>	L 200 mm

Composizione kit: 1 corpo contenitore, 1 cornice posteriore a scatto, 2 agganci / *Kit composition: 1 body enclosure, 1 rear frame with snap-lock mechanism, 2 plastic fastening elements.*

Il contenitore può essere fornito con misure (L) diverse dalle predefinite fino ad un massimo di 180 mm / *Special lengths (L) can be supplied upon request to a maximum of 180 mm.*

Accessories

CODICE / CODE	DESCRIZIONE / DESCRIPTION	DIMENSIONI / DIMENSIONS (LxHxS)
06.296 0000	Pannello frontale, Alluminio, anodizzato opaco / <i>Front panel, anodized aluminium, mat</i>	139,2x67,3x1,5
06.256 0000	Pannello frontale, PPO UL 94 V-0, nero / <i>Front panel, PPO UL 94 V-0, black</i>	139,3x65,3x2,0
06.355 0000	Pannello frontale, Plexiglass, trasparente / <i>Front panel, plexiglass, transparent</i>	139,2x67,3x2,0
06.205 0000	Pannello frontale, Plexiglass rosso, trasparente / <i>Front panel, red plexiglass, transparent</i>	139,2x67,3x2,0
06.345 0000	Pannello frontale, PC per raggi infrarossi / <i>Front panel, PC for infra-red rays</i>	139,2x67,4x2,0
06.315 0000	Pannello posteriore, Alluminio, anodizzato opaco / <i>Rear panel, anodized aluminium mat</i>	118,9x62,6x1,0
06.276 0000	Pannello posteriore, PPO UL 94 V-0, nero / <i>Rear panel, PPO UL 94 V-0, black</i>	118,7x62,7x2,0
06.375 0000	Pannello posteriore, PVC UL 94 V-0, nero / <i>Rear panel, PVC UL 94 V-0, black</i>	118,9x62,6x1,5

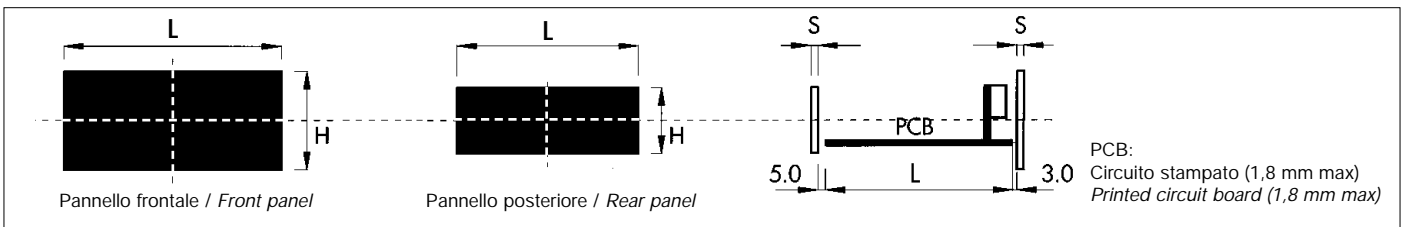

03.435 0000	Protezione IP54 / <i>Protection cover IP54</i>
03.445 0000	Protezione IP65 / <i>Protection cover IP65</i>

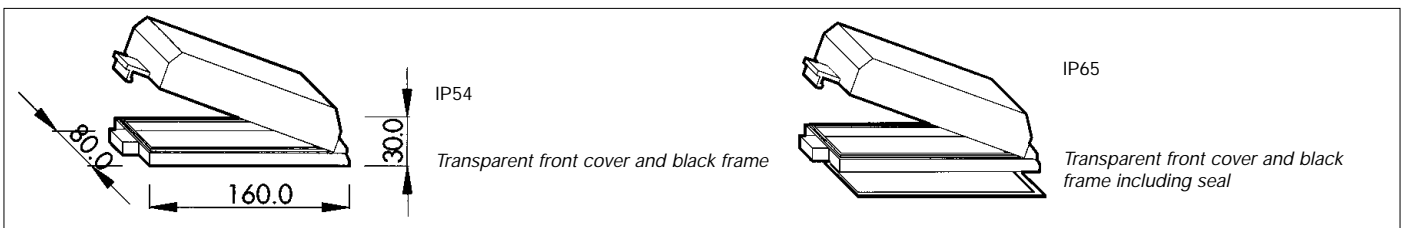

INCABOX

Panel mounting enclosures for electronic products according to DIN 43700

material: Self-extinguishing PPO
 colour: Black
 dimensions: 48x48x57/75/100/124/156

CARATTERISTICHE

Contenitore a montaggio rapido senza viti. La scheda elettronica si inserisce dalla parte posteriore nelle apposite guide fino alla battuta interna predisposta e viene bloccata dalla cornice posteriore con ritenuta a scatto tramite due ganci. I pannelli anteriori e posteriori sono ad inserimento rapido a scatto. Disponibili su richiesta misure (L) diverse dagli standard.

FEATURES

This enclosure can easily be assembled without the use of fixing screws. The PCB is inserted from the rear side of the enclosure using the internal PCB guides and it is fixed by the rear frame with a snap-lock mechanism. Either the front or the rear panels can be inserted into the enclosure by a snap-lock mechanism. Lengths (L) different from the standard ones are available upon request.

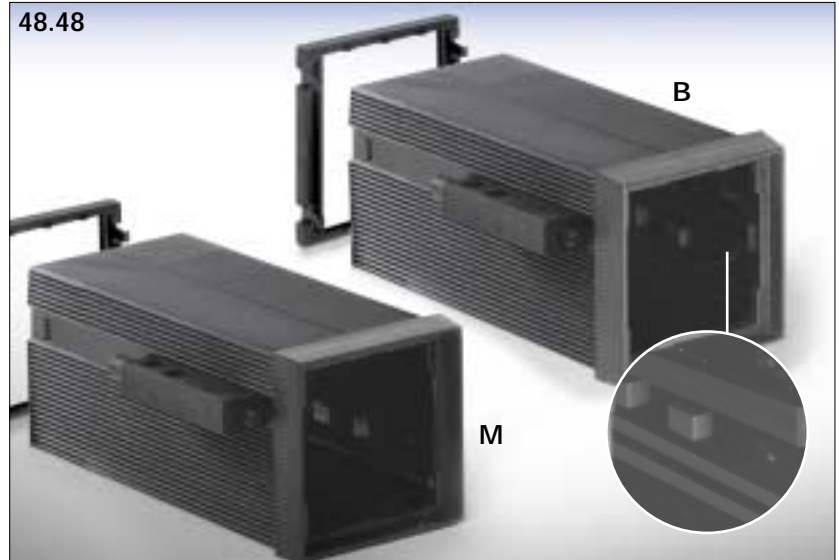

48.48 M

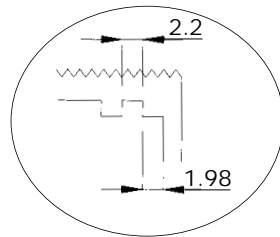
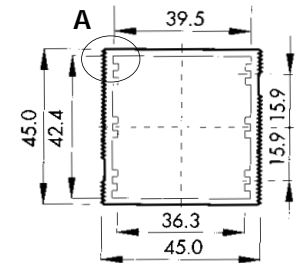
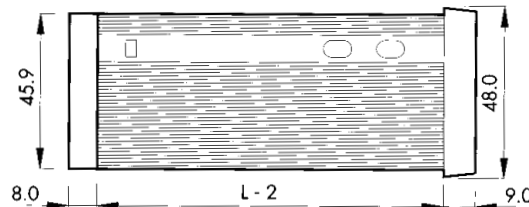
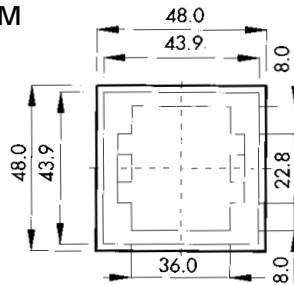

Sezione B
Section B

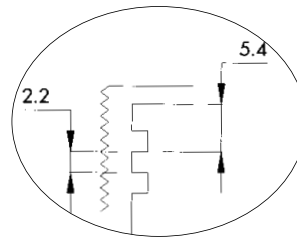
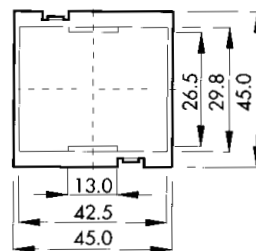

Sezione A
Section A

48.48 B

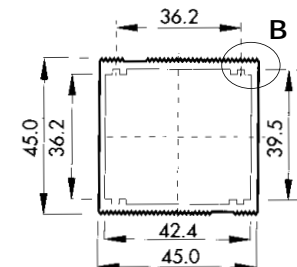
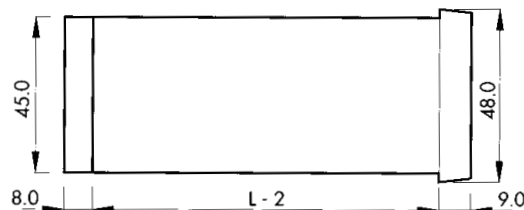
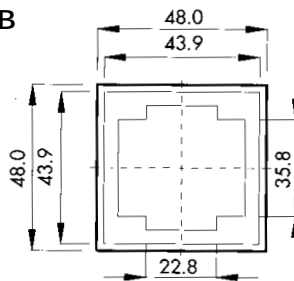

It indicates the product with the minimum number of internal guides
 It indicates the product with the maximum number of internal guides

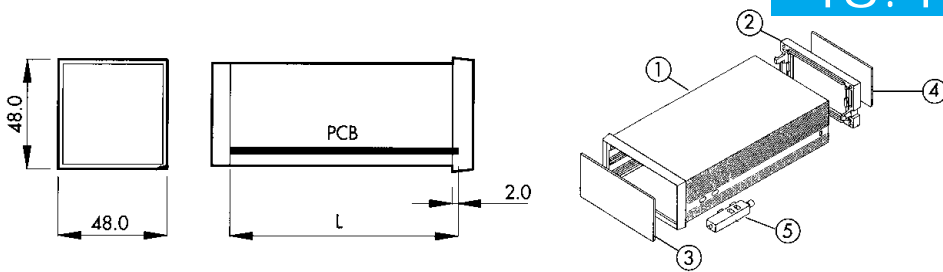
**Descrizione / Description:**

- 1) Corpo contenitore / *Body enclosure*
- 2) Cornice posteriore / *Rear frame*
- 3) Pannello frontale* / *Front panel**
- 4) Pannello posteriore* / *Rear panel**
- 5) Aggancio / *Fastening element*

* Accessori separati / *Separate accessories***Complete Enclosure**

CODICE / CODE	48.48 B	DESCRIZIONE / DESCRIPTION	CODICE / CODE	48.48 M
01.120 L057	L 57 mm	Contenitore completo / <i>Complete enclosure</i>	01.108 L057	L 57 mm
01.120 L075	L 75 mm	Contenitore completo / <i>Complete enclosure</i>	01.108 L075	L 75 mm
01.120 L100	L 100mm	Contenitore completo / <i>Complete enclosure</i>	01.108 L100	L 100 mm
01.120 L124	L 124 mm	Contenitore completo / <i>Complete enclosure</i>	01.108 L124	L 124 mm
01.120 LXXX	L 136 mm max	Contenitore completo / <i>Complete enclosure</i>	01.108 LXXX	L 136 mm max
LUNGHEZZE OTTIMIZZATE / <i>SPECIAL LENGTHS</i>				
01.120 L156	L 156 mm	Contenitore completo / <i>Complete enclosure</i>	01.108 L156	L 156 mm

Kit composition: 1 body enclosure, 1 rear frame with snap-lock mechanism, 2 plastic fastening elements.

Special lengths (L) can be supplied upon request to a maximum of 136 mm.

Accessories

CODICE / CODE	DESCRIZIONE / DESCRIPTION	DIMENSIONI / DIMENSIONS (LxHxS)
06.292 0000	Pannello frontale, Alluminio, anodizzato opaco / <i>Front panel, anodized aluminium, mat</i>	43,6x43,6x1,5
06.252 0000	Pannello frontale, PPO UL 94 V-0, nero / <i>Front panel, PPO UL 94 V-0, black</i>	43,7x43,7x2,0
06.351 0000	Pannello frontale, Plexiglass, trasparente / <i>Front panel, plexiglass, transparent</i>	43,6x43,6x2,0
06.201 0000	Pannello frontale, Plexiglass rosso, trasparente / <i>Front panel, red plexiglass, transparent</i>	43,6x43,6x2,0
06.341 0000	Pannello frontale, PC per raggi infrarossi / <i>Front panel, PC for infra-red rays</i>	43,7x43,7x2,0
06.311 0000	Pannello posteriore, Alluminio, anodizzato opaco / <i>Rear panel, anodized aluminium, mat</i>	42,2x29,6x1,0
06.272 0000	Pannello posteriore, PPO UL 94 V-0, nero / <i>Rear panel, PPO UL 94 V-0, black</i>	42,3x29,6x1,8
06.371 0000	Pannello posteriore, PVC UL 94 V-O, nero / <i>Rear panel, PVC UL 94 V-O, black</i>	42,2x29,6x1,5

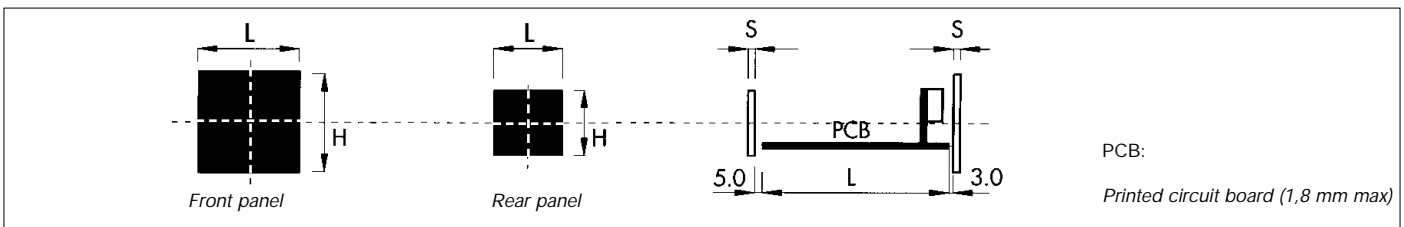

06.362 0000	Pannello posteriore, OCTAL con pins montati / <i>8 PIN rear panel with mounted pins (OCTAL)</i>	42,3x29,8x1,8
06.367 0000	Pannello posteriore, UNDECAL con pins montati / <i>11 PIN rear panel with mounted pins (UNDECAL)</i>	42,3x29,8x1,8

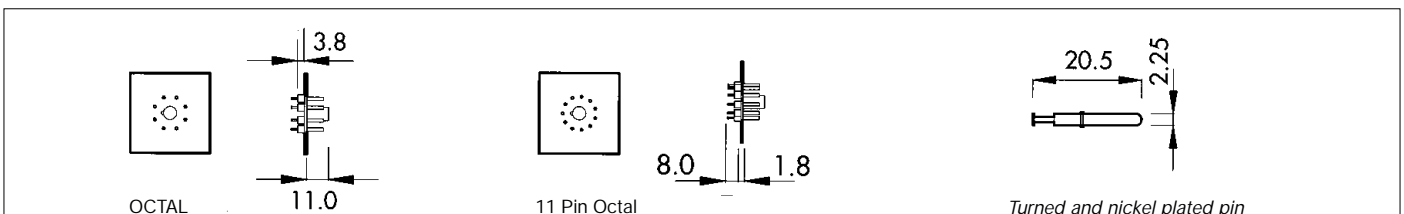

INCABOX

Panel mounting enclosures for electronic products according to DIN 43700

material: Self-extinguishing PPO
 colour: Black
 dimensions: 48x96x57/75/100/114/124/179

CARATTERISTICHE

Contenitore a montaggio rapido senza viti.
 La scheda elettronica si inserisce dalla parte posteriore nelle apposite guide fino alla battuta interna predisposta e viene bloccata dalla cornice posteriore con ritenuta a scatto tramite due ganci.
 I pannelli anteriori e posteriori sono ad inserimento rapido a scatto.
 Disponibili su richiesta misure (L) diverse dagli standard.

FEATURES

This enclosure can easily be assembled without the use of fixing screws. The PCB is inserted from the rear side of the enclosure using the internal PCB guides and it is fixed by the rear frame with a snap-lock mechanism. Either the front or the rear panels can be inserted into the enclosure by a snap-lock mechanism.
 Lengths (L) different from the standard ones are available upon request.

48.48

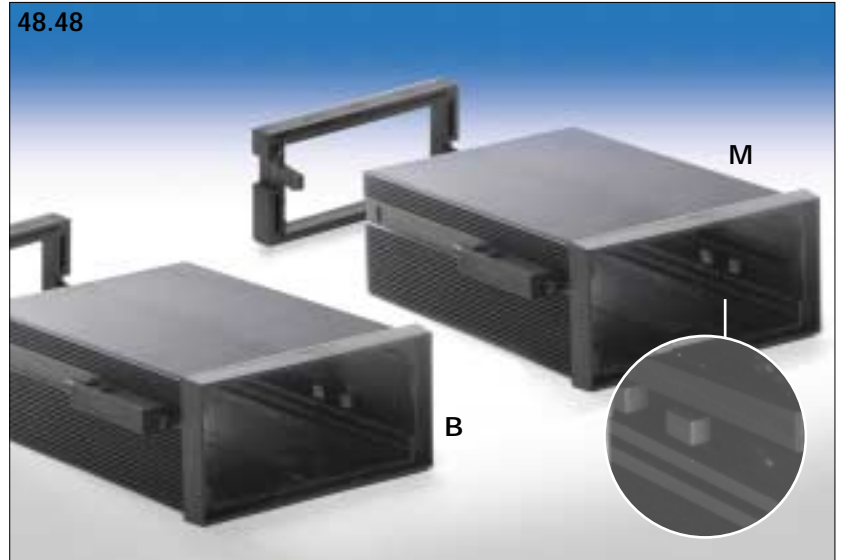

48.96 B

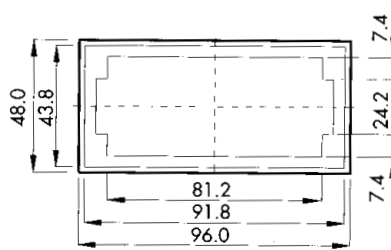

Sezione A
 Section A

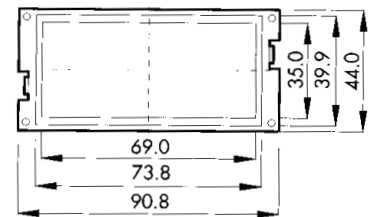
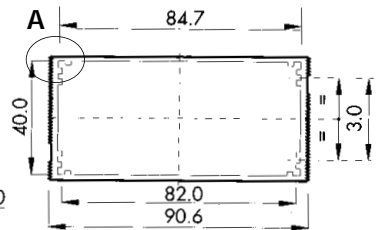
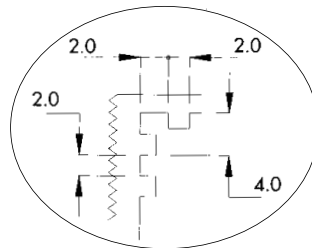

48.96 M

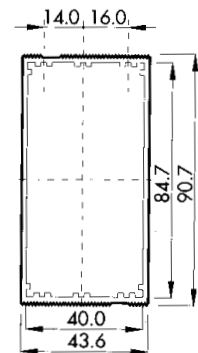
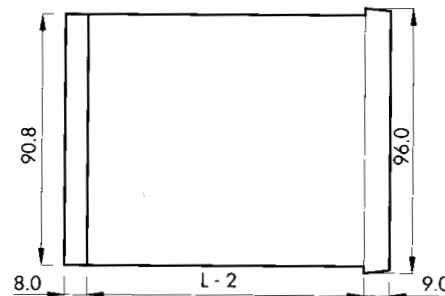
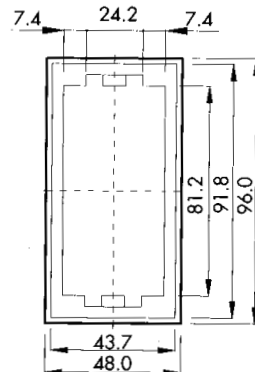

It indicates the product with the minimum number of internal guides
 It indicates the product with the maximum number of internal guides

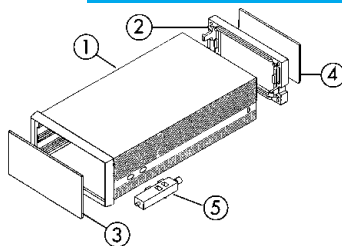
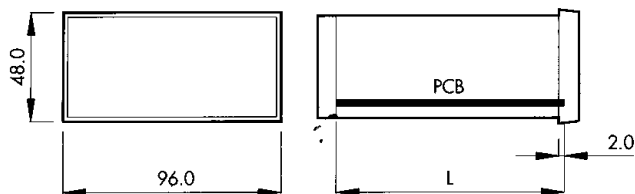
**Descrizione / Description:**

- 1) Corpo contenitore / *Body enclosure*
- 2) Cornice posteriore / *Rear frame*
- 3) Pannello frontale* / *Front panel**
- 4) Pannello posteriore* / *Rear panel**
- 5) Aggancio / *Fastening element*

* Accessori separati / *Separate accessories***Complete Enclosure**

CODICE / CODE	48.96 B	DESCRIZIONE / DESCRIPTION	CODICE / CODE	48.96 M
01.109 L057	L 57 mm	Contenitore completo / <i>Complete enclosure</i>	01.113 L057	L 57 mm
01.109 L075	L 75 mm	Contenitore completo / <i>Complete enclosure</i>	01.113 L075	L 75 mm
01.109 L100	L 100mm	Contenitore completo / <i>Complete enclosure</i>	01.113 L100	L 100 mm
01.109 L124	L 124 mm	Contenitore completo / <i>Complete enclosure</i>	01.113 L124	L 124 mm
01.109 LXXX	L 104 mm max	Contenitore completo / <i>Complete enclosure</i>	01.113 LXXX	L 159 mm max
LUNGHEZZE OTTIMIZZATE / SPECIAL LENGTHS				
01.109 L114	L 114 mm	Contenitore completo / <i>Complete enclosure</i>	01.113 L114	L 114 mm
		Contenitore completo / <i>Complete enclosure</i>	01.113 L179	L 179mm

Composizione kit: 1 corpo contenitore, 1 cornice posteriore a scatto, 2 agganci / *Kit composition: 1 body enclosure, 1 rear frame with snap-lock mechanism, 2 plastic fastening elements.*

Il contenitore può essere fornito con misure (L) diverse dalle predefinite fino ad un massimo come indicato / *Special lengths (L) can be supplied upon request to a maximum as shown.*

Accessories

CODICE / CODE	DESCRIZIONE / DESCRIPTION	DIMENSIONI / DIMENSIONS (LxHxS)
06.293 0000	Pannello frontale, Alluminio, anodizzato opaco / <i>Front panel, anodized aluminium, mat</i>	91,5x43,4x1,5
06.253 0000	Pannello frontale, PPO UL 94 V-0, nero / <i>Front panel, PPO UL 94 V-0, black</i>	91,6x43,5x2,0
06.352 0000	Pannello frontale, Plexiglass, trasparente / <i>Front panel, plexiglass, transparent</i>	91,5x43,4x2,0
06.202 0000	Pannello frontale, Plexiglass rosso, trasparente / <i>Front panel, red plexiglass, transparent</i>	91,5x43,4x2,0
06.342 0000	Pannello frontale, PC per raggi infrarossi / <i>Front panel, PC for infra-red rays</i>	91,6x43,5x2,0
06.312 0000	Pannello posteriore, Alluminio, anodizzato opaco / <i>Rear panel, anodized aluminium, mat</i>	73,5x39,6x1,0
06.273 0000	Pannello posteriore, PPO UL 94 V-0, nero / <i>Rear panel, PPO UL 94 V-0, black</i>	73,8x39,7x1,7
06.372 0000	Pannello posteriore, PVC UL 94 V-O, nero / <i>Rear panel, PVC UL 94 V-O, black</i>	73,5x39,6x1,5

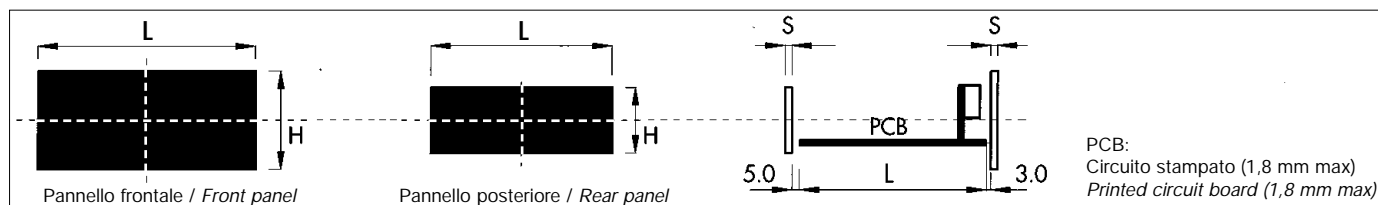

06.364 0000	Pannello posteriore, OCTAL con pins montati / <i>8 PIN rear panel with mounted pins (OCTAL)</i>	73,8x39,9x2,0
06.368 0000	Pannello posteriore, UNDECAL con pins montati / <i>11 PIN rear panel with mounted pins (UNDECAL)</i>	73,6x39,9x2,0

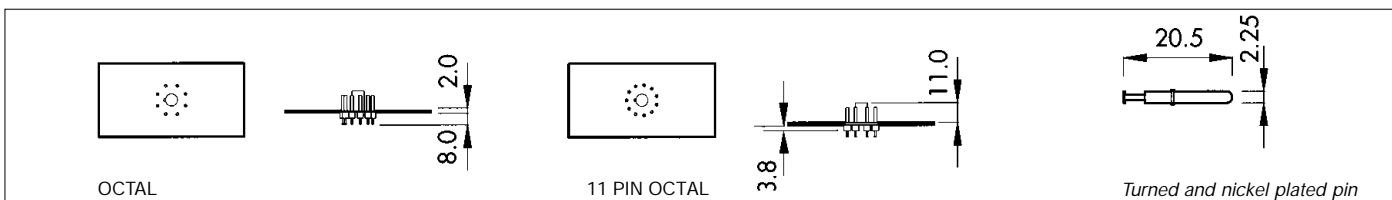

03.432 0000	Protezione IP54 / <i>Protection cover IP54</i>
03.442 0000	Protezione IP65 / <i>Protection cover IP65</i>

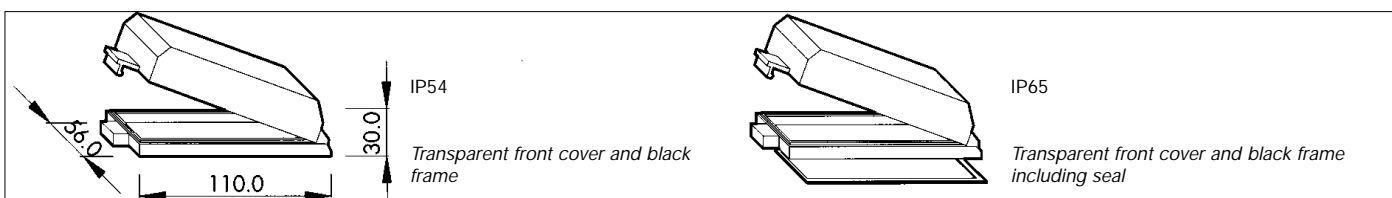

INCABOX

Panel mounting enclosures for electronic products according to DIN 43700

material: Self-extinguishing PPO
 colour: Black
 dimensions: 96x96x57/75/100/124/179

CARATTERISTICHE

Contenitore a montaggio rapido senza viti. La scheda elettronica si inserisce dalla parte posteriore nelle apposite guide fino alla battuta interna predisposta e viene bloccata dalla cornice posteriore con ritenuta a scatto tramite due ganci. I pannelli anteriori e posteriori sono ad inserimento rapido a scatto. Disponibili su richiesta misure (L) diverse dagli standard.

FEATURES

This enclosure can easily be assembled without the use of fixing screws. The PCB is inserted from the rear side of the enclosure using the internal PCB guides and it is fixed by the rear frame with a snap-lock mechanism. Either the front or the rear panels can be inserted into the enclosure by a snap-lock mechanism. Lengths (L) different from the standard ones are available upon request.



96.96 B

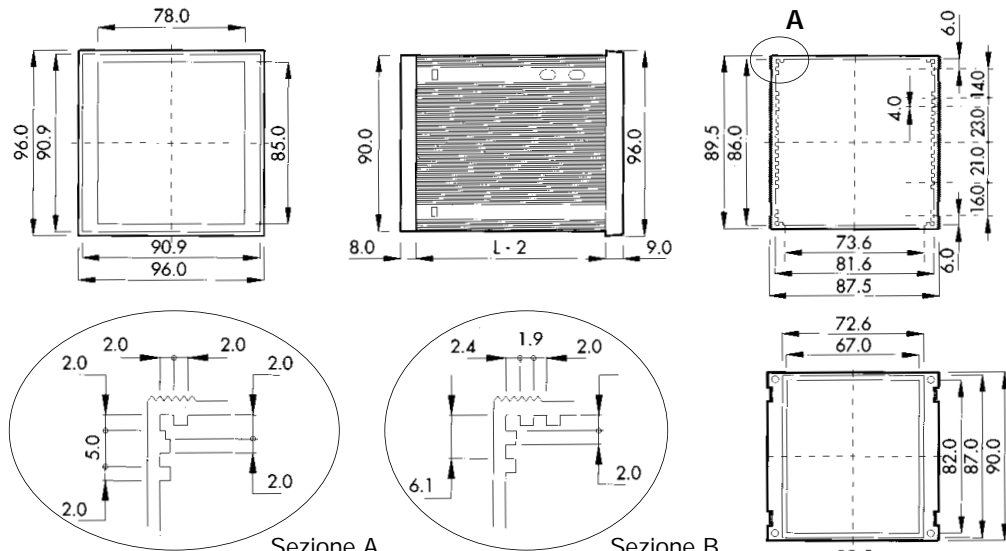

96.96 MS2

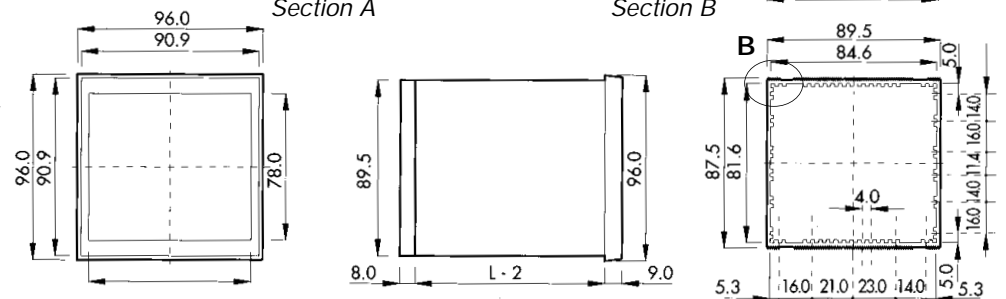

It indicates the product with the minimum number of internal guides
 It indicates the possibility to assemble the PCBs on both sides of the enclosure
 It indicates the product with the maximum number of internal guides

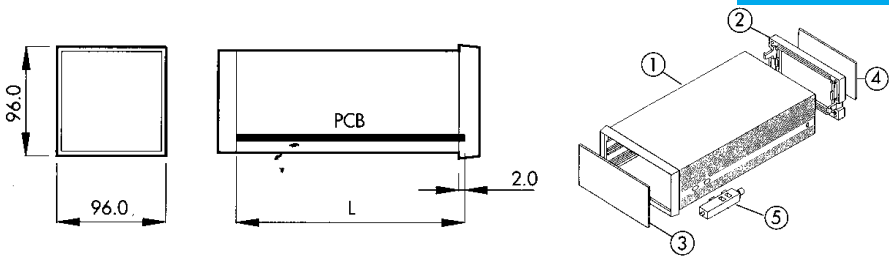
**Descrizione / Description:**

- 1) Corpo contenitore / *Body enclosure*
- 2) Cornice posteriore / *Rear frame*
- 3) Pannello frontale* / *Front panel**
- 4) Pannello posteriore* / *Rear panel**
- 5) Aggancio / *Fastening element*

* Accessori separati / *Separate accessories***Complete Enclosure**

CODICE / CODE	96.96 B	DESCRIZIONE / DESCRIPTION	CODICE / CODE	96.96 MS2
01.111 L057	L 57 mm	Contenitore completo / <i>Complete enclosure</i>	01.114 L057	L 57 mm
01.111 L075	L 75 mm	Contenitore completo / <i>Complete enclosure</i>	01.114 L075	L 75 mm
01.111 L100	L 100mm	Contenitore completo / <i>Complete enclosure</i>	01.114 L100	L 100 mm
01.111 L124	L 124 mm	Contenitore completo / <i>Complete enclosure</i>	01.114 L124	L 124 mm
01.111 LXXX	L 104 mm max	Contenitore completo / <i>Complete enclosure</i>	01.114 LXXX	L 159 mm max
LUNGHEZZE OTTIMIZZATE / SPECIAL LENGTHS				
		Contenitore completo / <i>Complete enclosure</i>	01.114 L179	L 179mm

Composizione kit: 1 corpo contenitore, 1 cornice posteriore a scatto, 2 agganci / *Kit composition: 1 body enclosure, 1 rear frame with snap-lock mechanism, 2 plastic fastening elements.*

Il contenitore può essere fornito con misure (L) diverse dalle predefinite fino ad un massimo come indicato / *Special lengths (L) can be supplied upon request to a maximum as shown.*

Accessories

CODICE / CODE	DESCRIZIONE / DESCRIPTION	DIMENSIONI / DIMENSIONS (LxHxS)
06.295 0000	Pannello frontale, Alluminio, anodizzato opaco / <i>Front panel, anodized aluminium, mat</i>	90,6x90,6x1,5
06.255 0000	Pannello frontale, PPO UL 94 V-0, nero / <i>Front panel, PPO UL 94 V-0, black</i>	90,7x90,7x2,2
06.354 0000	Pannello frontale, Plexiglass, trasparente / <i>Front panel, plexiglass, transparent</i>	90,6x90,6x2,0
06.204 0000	Pannello frontale, Plexiglass rosso, trasparente / <i>Front panel, red plexiglass, transparent</i>	90,6x90,6x2,0
06.344 0000	Pannello frontale, PC per raggi infrarossi / <i>Front panel, PC for infra-red rays</i>	90,7x90,7x2,2
06.314 0000	Pannello posteriore, Alluminio, anodizzato opaco / <i>Rear panel, anodized aluminium, mat</i>	86,7x71,7x1,5
06.275 0000	Pannello posteriore, PPO UL 94 V-0, nero / <i>Rear panel, PPO UL 94 V-0, black</i>	86,7x71,8x1,7
06.374 0000	Pannello posteriore, PVC UL 94 V-0, nero / <i>Rear panel, PVC UL 94 V-0, black</i>	86,7x71,7x1,5
06.275 0001	Pannello posteriore, PPO UL 94 V-0, nero con cornice integrata / <i>Rear panel, PPO UL 94 V-0, black with integrated frame</i>	

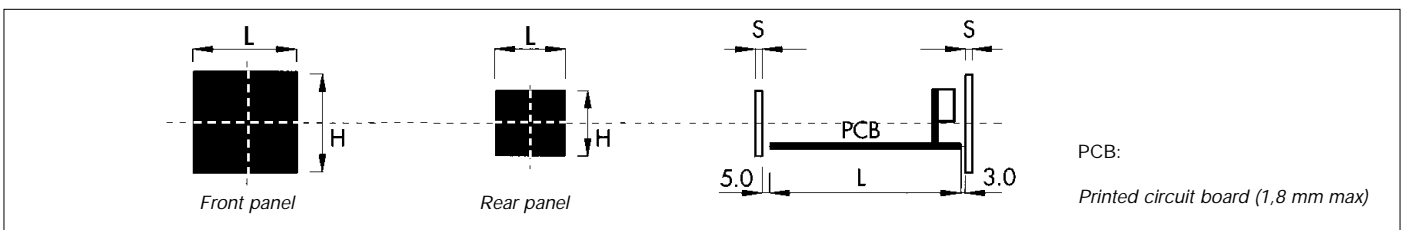

03.434 0000	Protezione IP54, coperchio frontale trasparente e cornice nera / <i>Protection cover IP54, transparent front cover and black frame</i>
03.444 0000	Protezione IP65, completa di guarnizione / <i>Protection cover IP65, including seal</i>

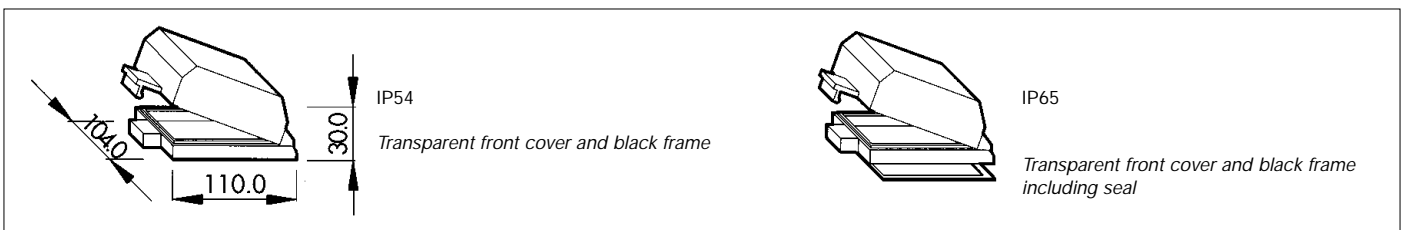

INCABOX

Panel mounting enclosures for electronic products according to DIN 43700

material: Self-extinguishing PPO
 colour: Black
 dimensions: 144x144x57/75/100/114/139/156

CARATTERISTICHE

Frontale: Pannello in materiale plastico o alluminio di spessore 1.5-3 mm. Possibilità di fissaggio dei pannelli anteriori tramite quattro viti.

Posteriore: Pannello in materiale plastico o alluminio di spessore 1.5-2 mm.

Montaggio: Il contenitore è studiato per l'inserimento dei circuiti stampati dalla parte anteriore o posteriore.

FEATURES

Front: Plastic or aluminium panels; thickness: 1.5-3 mm. Possibility to fix the front panels with four screws.

Rear: Plastic or aluminium panels; thickness: 1.5-2 mm.

Assembly method: This enclosure has been designed to insert the PCB either from the rear side or from the front side.



144.144MS2

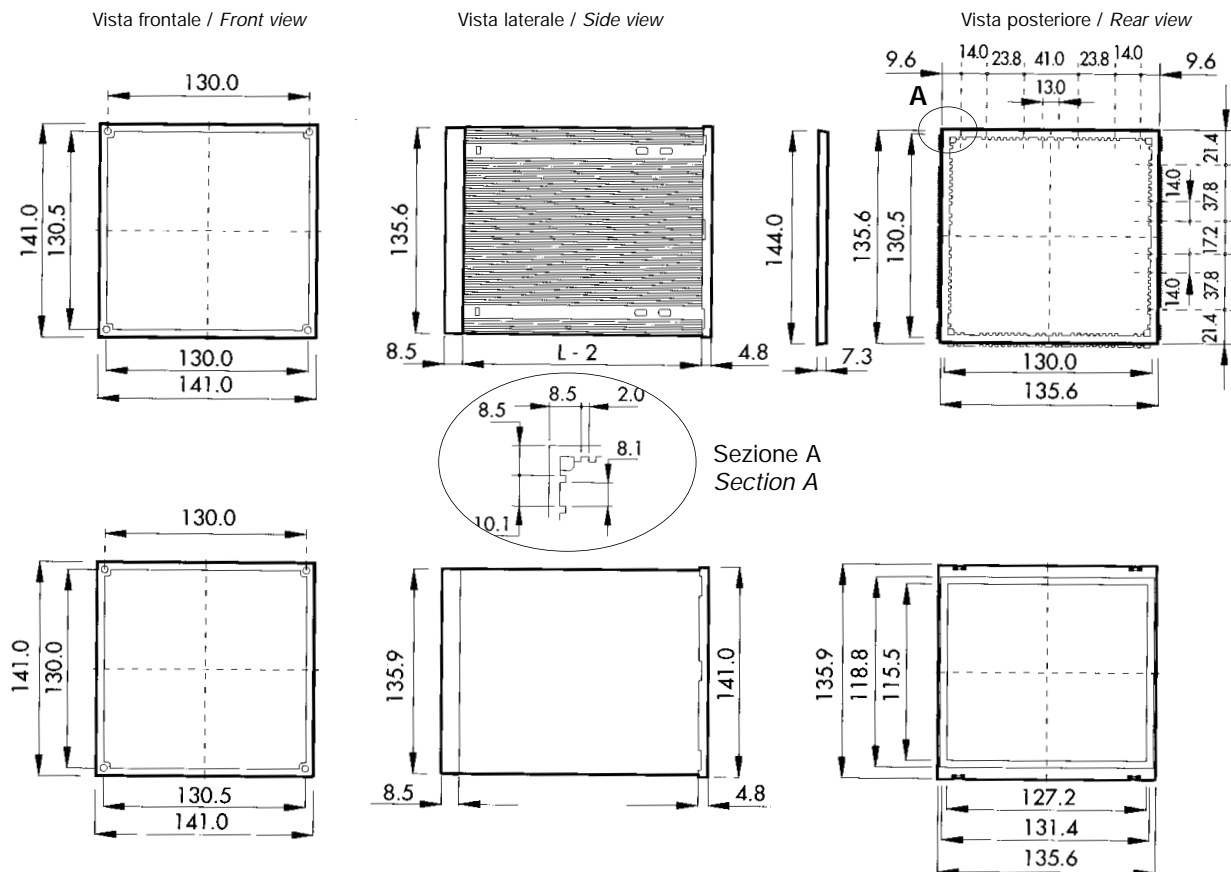

It indicates the possibility to assemble the PCBs on both sides of the enclosure
 It indicates the product with the maximum number of internal guides

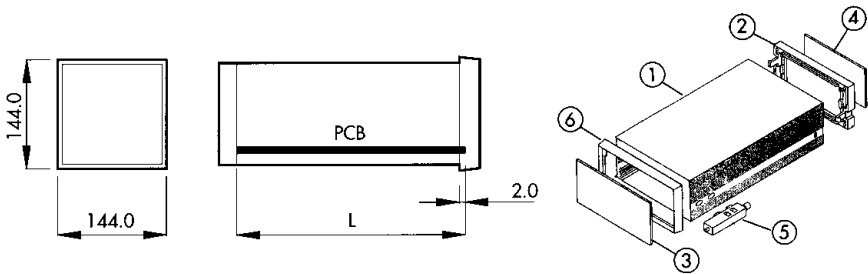

Descrizione / Description:

- 1) Corpo contenitore / Body enclosure
- 2) Cornice posteriore / Rear frame
- 3) Pannello frontale* / Front panel*
- 4) Pannello posteriore* / Rear panel*
- 5) Aggancio / Fastening element
- 6) Cornice anteriore / Front frame

* Separate accessories

Complete Enclosure

CODICE / CODE	DESCRIZIONE / DESCRIPTION	144.144 MS2
01.509 L057	Contenitore completo / Complete enclosure	L 57 mm
01.509 L075	Contenitore completo / Complete enclosure	L 75 mm
01.509 L100	Contenitore completo / Complete enclosure	L 100 mm
LUNGHEZZE OTTIMIZZATE / SPECIAL LENGTHS		
01.509 L114	Contenitore completo / Complete enclosure	L 114 mm
01.509 L139	Contenitore completo / Complete enclosure	L 139 mm
01.509 L156	Contenitore completo / Complete enclosure	L 156 mm

Composizione kit: 1 corpo contenitore, 1 cornice posteriore a scatto, 2 agganci, 1 cornice anteriore a scatto

Kit composition: 1 body enclosure, 1 rear frame with snap-lock mechanism, 2 plastic fastening elements, 1 front frame with snap-lock mechanism

Accessories

CODICE / CODE	DESCRIZIONE / DESCRIPTION	DIMENSIONI / DIMENSIONS (LxHxS)
06.298 0000	Pannello frontale, Alluminio, anodizzato opaco, con 4 fori / Front panel, anodized aluminium, mat, with 4 holes	138 x 138 x 2,0
06.258 0000	Pannello frontale, PVC nero, con 4 fori / Front panel, PVC black, with 4 holes	138 x 138 x 2,0
06.357 0000	Pannello frontale, Plexiglass trasparente, con 4 fori / Front panel, plexiglass, transparent, with 4 holes	138 x 138 x 2,0
06.358 0000	Pannello frontale, Plexiglass trasparente con 3 mm / Front panel, plexiglass, transparent, 3 mm	138 x 138 x 3,0
06.207 0000	Pannello frontale, Plexiglass rosso trasparente, con 4 fori / Front panel, plexiglass, red transparent, with 4 holes	138 x 138 x 2,0
06.209 0000	Pannello frontale, Plexiglass rosso trasparente, con 3 mm / Front panel, plexiglass, red transparent, 3 mm	138 x 138 x 3,0
06.316 0000	Pannello posteriore, Alluminio anodizzato opaco / Rear panel, anodized aluminium, mat	118,6 x 131,3 x 1,5
06.376 0000	Pannello posteriore, PVC nero / Rear panel, PVC black	118,6 x 131,3 x 1,5
06.208 0000	Kit per fissaggio, pannello frontale, 2 mm / Kit to fix front panel, 2 mm	
06.211 0000	Kit per fissaggio, pannello frontale, 3 mm / Kit to fix front panel, 3 mm	

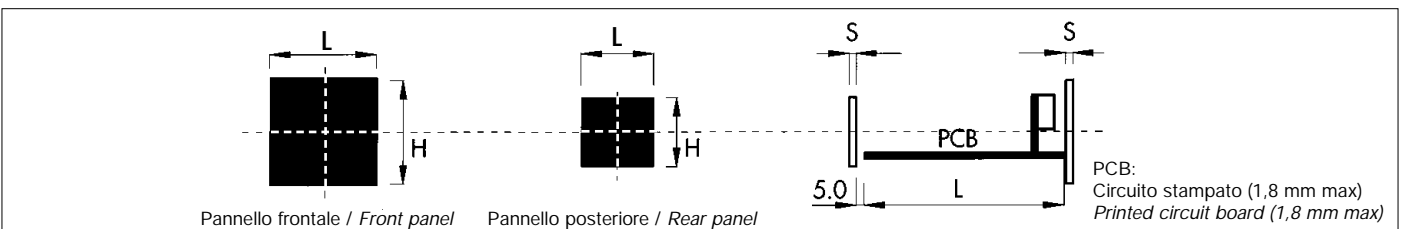

03.436 000	Protezione IP54, coperchio frontale trasparente e cornice nera / Protection cover IP54, transparent front cover and black frame
03.446 000	Protezione IP65, completa di guarnizione / Protection cover IP65, including seal

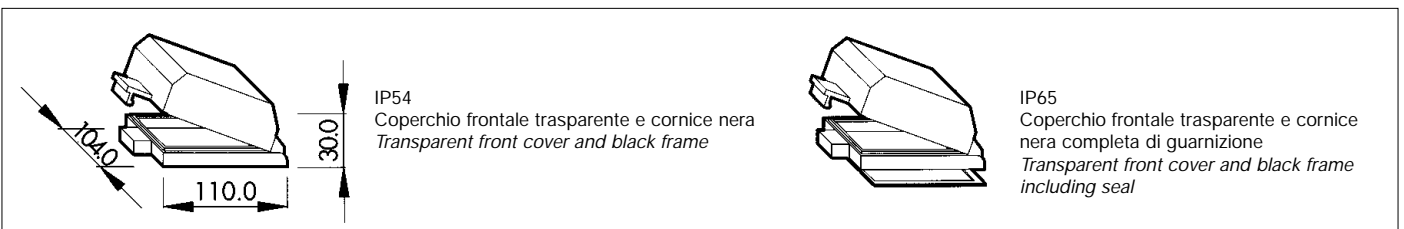

INCABOX

Contenitore per strumentazione elettronica da incasso secondo norme DIN 43700 con elettronica estraibile dal frontale e connessioni posteriori tipo vite.

INCABOX

Panel mounting enclosure for electronic products according to DIN 43700 manufactured to remove the electronic devices from the front side and rear-screw-type-connections.

material: Self-extinguishing ABS
colour: Black
dimensions: 48x48x69/83/109

CARATTERISTICHE

Frontale:

Versione singolo display (1D):
 n. 3 DIGIT (0.4" h = 7 mm)
 n. 4 TASTI max. (h = 7 mm)
 n. 6 LED max. (diam. 3 mm)
 Versione doppio display con indicazione principale (2D):
 n. 4 DIGIT (0.3"; h = 7 mm)
 Indicazione secondaria:
 n.4 DIGIT (0.2"; h = 6 mm)
 n. 4 TASTI max. (h = 7 mm)
 n. 6 LED max. (diam. 3 mm)
 Versione speciale con area per indicazione 29x40 (S1):
 n. 4 TASTI max. (h = 7 mm)
 disponibile solo su richiesta

Posteriore:

Versione con n. 18 connessioni tipo vite.
 Versione con n. 10 connessioni tipo vite.

Montaggio:

Il contenitore è studiato per l'inserimento frontale dei circuiti stampati premontati nell'apposita cornice portacircuiti.

FEATURES

Front:

Single display version (1D):
 no. 3 DIGIT (0.4" h = 7 mm)
 no. 4 SWICTHES max. (h = 7 mm)
 no. 6 LED max. (diam. 3 mm)
 Double display version with main indicator (2D):
 n. 4 DIGIT (0.3"; h = 7 mm)
 Secondary indicator:
 n.4 DIGIT (0.2"; h = 6 mm)
 n. 4 SWICTHES max. (h = 7 mm)
 n. 6 LED max. (diam. 3 mm)
 Special version with space for 29 x 40 indicator (S1):
 n. 4 SWICTHES max. (h = 7 mm)
 available upon request only.

Rear:

Version with 18 screw type connections.
 Version with 10 screw type connections.

Assembly method:

This enclosure has been designed to insert the PCBs which are already mounted in their frame holder from the front side.

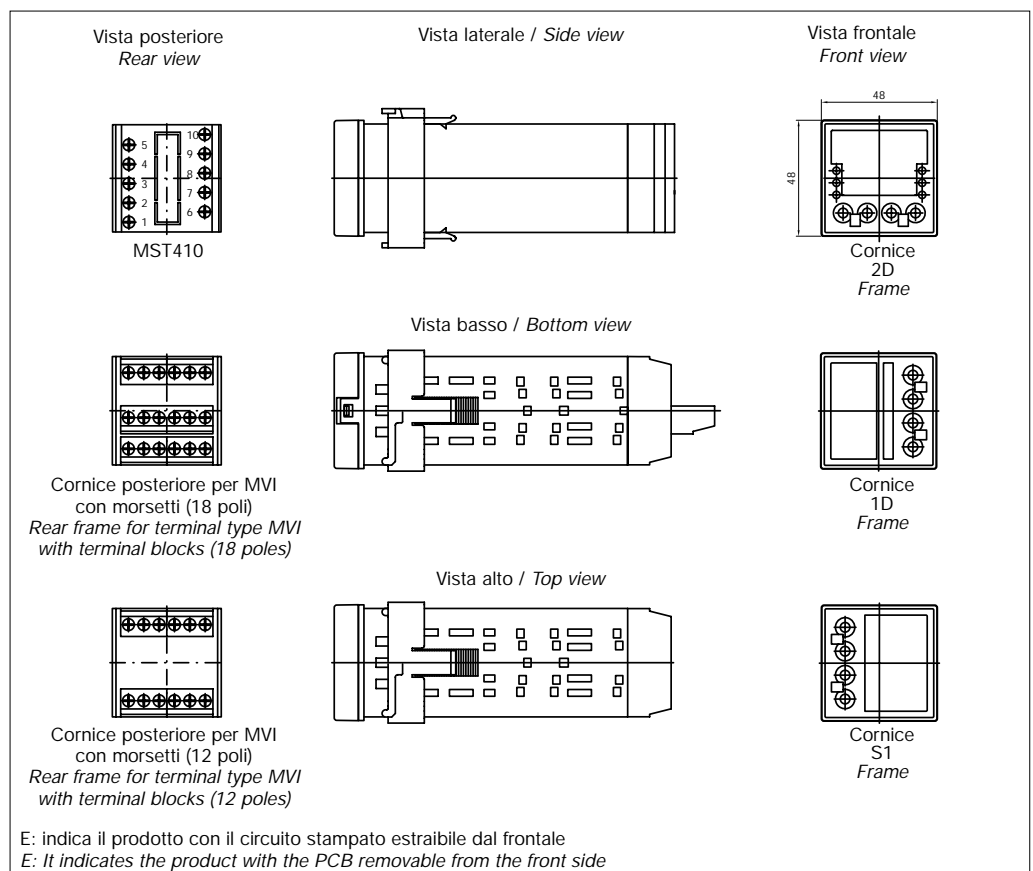
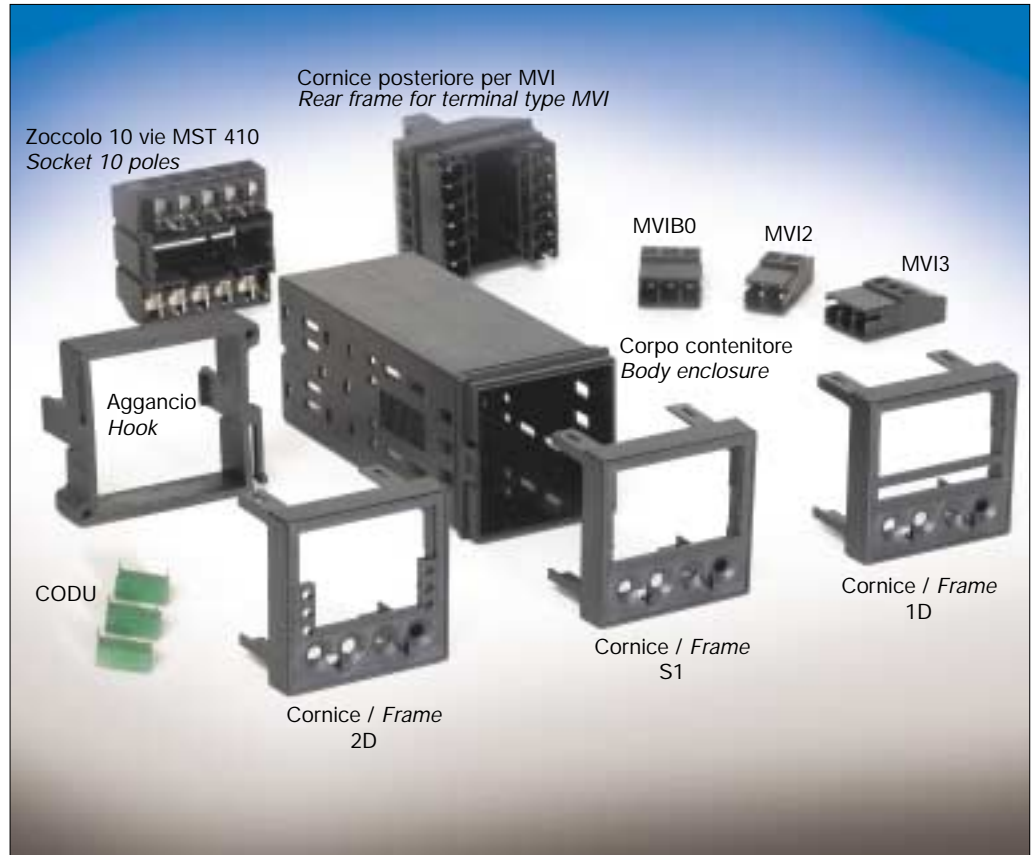

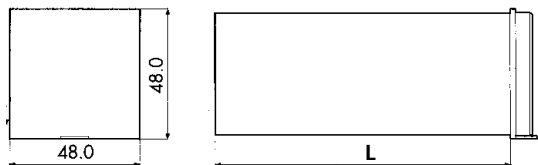

Contenitore Completo / Complete Enclosure

CODICE / CODE	DESCRIZIONE / DESCRIPTION	48.48 E
02.108 L069	Contenitore / Enclosure	L 69 mm
02.108 L083	Contenitore / Enclosure	L 83 mm
02.108 L109	Contenitore / Enclosure	L 109 mm

Composizione kit: 1 corpo contenitore, 1 aggancio / *Kit composition: 1 body enclosure, 1 fastening element.*

Accessori / Accessories

CODICE / CODE	DESCRIZIONE / DESCRIPTION
P02540001D	cornice EV1D / <i>Frame EV1D</i>
P02540002D	cornice EV2D / <i>Frame EV2D</i>
P02540001S	cornice EVS1 / <i>Frame EVS1</i>

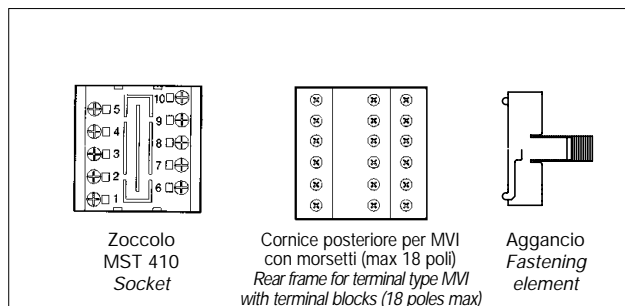
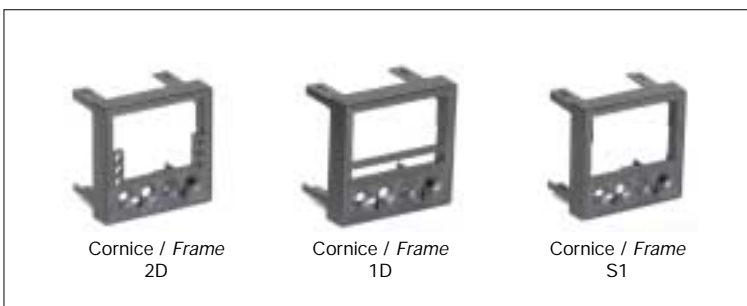

P02330201C	48x48E cornice posteriore per morsetto tipo MVI / <i>48x48E rear frame for terminal type MVI</i>
21.190 2062	Morsetto a inserzione diretta passo 6,35 nero tipo MVI2 a 2 vie / <i>Terminal, direct insertion pitch 6,35, black, type MVI2, 2 poles</i>
21.190 3062	Morsetto a inserzione diretta passo 6,35 nero tipo MVI3 a 3 vie / <i>Terminal, direct insertion pitch 6,35, black, type MVI3, 3 poles</i>
21.190 1122	Morsetto a inserzione diretta passo 12,7 nero tipo MVIA a 1 via / <i>Terminal, direct insertion pitch 12,7, black, type MVIA, 1 pole</i>
21.190 2122	Morsetto a inserzione diretta passo 12,7 nero tipo MVIB a 2 vie / <i>Terminal, direct insertion pitch 12,7, black, type MVIB, 2 poles</i>
21.190 2002	Morsetto a inserzione diretta nero tipo MVIAO / <i>Terminal, direct insertion, black, type MVIAO</i>
21.190 3002	Morsetto a inserzione diretta nero tipo MVIBO / <i>Terminal, direct insertion, black, type MVIBO</i>
P0254000CU	Connettore unipolare CODU / <i>CODU one single pole connector</i>
P02540010Z	Zoccolo 10 vie MST 410 / <i>Socket 10 poles MST 410</i>

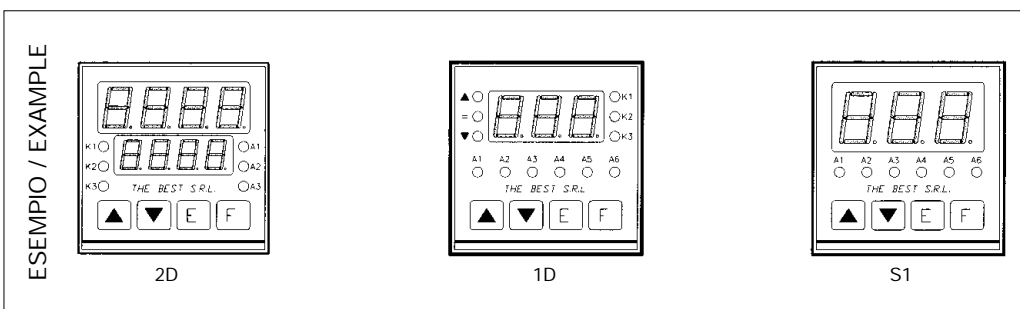

For more information on MVI terminals, see *TERMINAL* section.

Rear frame for terminal type MVI with terminal blocks (18 poles max)

INCABOX

Panel mounting enclosure for electronic products according to DIN 43700 manufactured to remove the electronic devices from the front side and rear-screw-type-connections. Available even with IP65 protection degree.

material: Self-extinguishing PPO
colour: Black
dimensions: 48x96x57/75/100/124/179

CARATTERISTICHE

Frontale: Versione 6T con indicazione superiore: n. 5 DIGIT (0.4"; h = 7 o 8 mm) indicazione intermedia. N. 4 DIGIT (0.3" h = 6 mm) indicazione inferiore. N. 4 DIGIT (0.3"; h = 6 mm) n. 12 LED max. (diam. 3 mm) n. 6 TASTI max. (h = 7 mm).

È possibile ottenere configurazioni diverse eliminando le linguette in plastica preincise disposte sul lato sinistro del frontale e le parti in plastica di separazione fra i display (h = 2 mm). Versione 4T le caratteristiche sono come le indicate per la versione 6 T ma è predisposta per l'equipaggiamento di soli 4 TASTI con una superficie per l'attuazione maggiore. Versione STANDARD A con una zona indicazione di dimensioni 44 x 38 ed una zona tasti 20 x 38; adatta per utilizzo di display con spessore h = 8 mm.

Posteriore: Versione con n. 36 connessioni tipo vite. Versione con n. 18 (max) connessioni tipo vite. Versione n. 24 connessioni tipo vite.

Montaggio: Il contenitore è studiato per l'inserimento frontale dei circuiti premontati nell'apposita cornice portacircuiti.

FEATURES

Front: 6T version with top indicator: n. 5 DIGIT (0.4"; h = 7 o 8 mm) version with intermediate indicator. N. 4 DIGIT (0.3" h = 6 mm) version with lower indicator. n. 4 DIGIT (0.3"; h = 6 mm) n. 12 LED max. (diam. 3 mm) n. 6 SWITCHES max. (h = 7 mm). It is possible to obtain different configurations by eliminating the engraved plastic splines on the left side of the front panel and the plastic pieces that separate the display (h = 2 mm).

4T version. The features are like those indicated in the 6 SWITCHES version but it is suitable to 4 SWITCHES only and this has more operating surface.

STANDARD A version with an indicator area 44 x 38 and an area for switches 20 x 38; suitable to use of displays with h = 8 mm.

Rear: Version with n. 36 screws-type connections. Version with n. 18 (max) screws-type-connections. Version with n. 24 screws-type-connections.

Assembly method:

This enclosure has been designed to insert the PCBs which are already mounted in their frame holder from the front side.

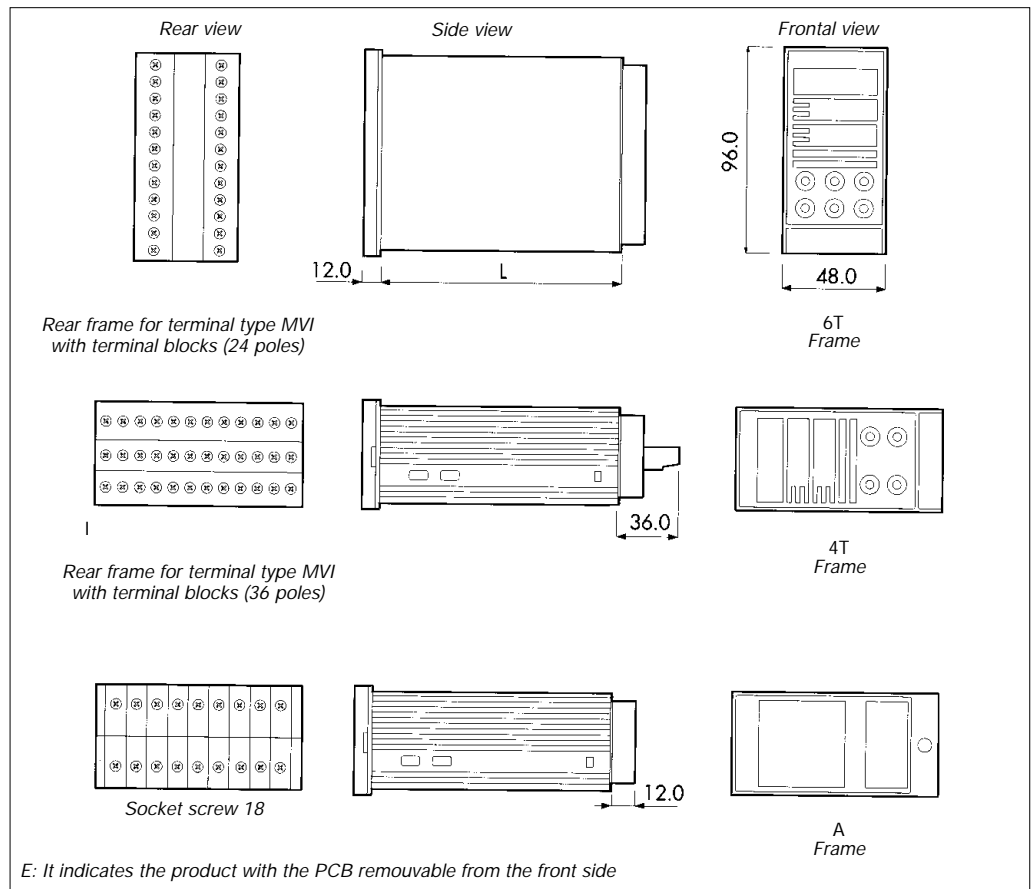

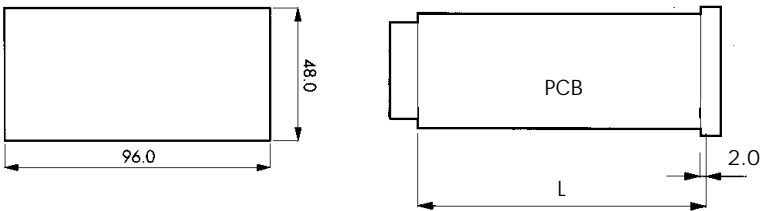

Contenitore Completo / Complete Enclosure

CODICE / CODE	DESCRIZIONE / DESCRIPTION	48.96 E
02.502 L057	Contenitore completo / Complete enclosure	L 57 mm
02.502 L075	Contenitore completo / Complete enclosure	L 75 mm
02.502 L100	Contenitore completo / Complete enclosure	L 100 mm
02.502 L124	Contenitore completo / Complete enclosure	L 124 mm
02.502 LXXX	Contenitore completo / Complete enclosure	L 159 mm max
LUNGHEZZE OTTIMIZZATE / SPECIAL LENGTH		
02.502 L179	Contenitore completo / Complete enclosure	L 179 mm

Composizione kit: 1 corpo contenitore, 2 agganci, 1 inserto in ottone / Kit composition: 1 body enclosure, 2 fastening elements, 1 brass insert.

Il contenitore può essere fornito con misure (L) diverse dalle predefinite fino ad un massimo di 159 mm / Special lengths (L) can be supplied upon request to a maximum of 159 mm.

Accessori / Accessories

CODICE / CODE	DESCRIZIONE / DESCRIPTION
02.511 A000 kit A	1 cornice A, 1 vite, 1 rondella, 1 grower / 1 frame A, 1 screw, 1 circlip, 1 grower
02.511 B000 kit B	1 cornice B, 1 vite, 1 rondella, 1 grower / 1 frame B, 1 screw, 1 circlip, 1 grower
02.511 C000 kit 4T	1 cornice 4T, 1 vite, 1 rondella, 1 grower / 1 frame 4T, 1 screw, 1 circlip, 1 grower
02.511 D000 kit 6T	1 cornice 6T, 1 vite, 1 rondella, 1 grower / 1 frame 6T, 1 screw, 1 circlip, 1 grower
02.511 S000 kit S*	1 cornice S, 1 vite, 1 rondella, 1 grower / 1 frame S, 1 screw, 1 circlip, 1 grower
02.510 0000	zoccolo in plastica 18 vie / plastic socket 18 poles
02.526 0000 kit VN	1 vite, 1 contatto nichelato, 1 dado quadrato / 1 screw, 1 nickel pin, 1 square nut

* Codice generico per cornice speciale / * Generic code for special frame

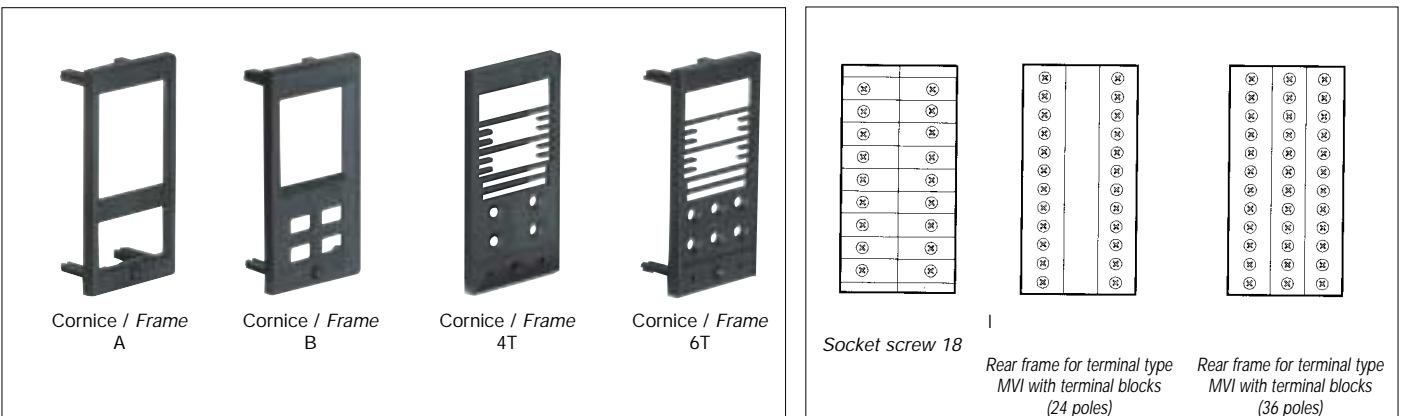

P02350 201C	Cornice posteriore 48x48E per morsetto tipo MVI / 48x48E rear frame for terminal type MVI
21.190 2062	Morsetto a inserzione diretta passo 6,35 nero tipo MVI2 a 2 vie / Terminal, direct insertion pitch 6,35, black, type MVI2, 2 poles
21.190 3062	Morsetto a inserzione diretta passo 6,35 nero tipo MVI3 a 3 vie / Terminal, direct insertion pitch 6,35, black, type MVI3, 3 poles
21.190 1122	Morsetto a inserzione diretta passo 12,7 nero tipo MVIA a 1 via / Terminal, direct insertion pitch 12,7, black, type MVIA, 1 pole
21.190 2122	Morsetto a inserzione diretta passo 12,7 nero tipo MVIB a 2 vie / Terminal, direct insertion pitch 12,7, black, type MVIB, 2 poles
21.190 2002	Morsetto a inserzione diretta nero tipo MVIAO / Terminal, direct insertion, black, type MVIAO
21.190 3002	Morsetto a inserzione diretta nero tipo MVIBO / Terminal, direct insertion, black, type MVIBO

Per maggiori informazioni sui morsetti MVI vedi sezione TERMINAL / For more information on MVI terminals, see TERMINAL section.



Cornice posteriore per MVI con morsetti (max 36 poli)
Rear frame for terminal type MVI with terminal blocks (36 poles max)

INCABOX - INCABOX XT

Aggancio

Sono disponibili due tipi di agganci per l'INCABOX: **Agganci in plastica** - sono gli agganci standard forniti con i contenitori. In virtù della non conducibilità della plastica, garantiscono che i circuiti del dispositivo interno del contenitore siano isolati dall'esterno. **Agganci in metallo** - sono agganci che garantiscono una maggiore resistenza meccanica.

Two types of fastening elements are available for INCABOX enclosures: **plastic fastening elements** and **metal fastening elements**. The plastic fastening elements are supplied as standard together with the enclosures. As plastic is a non conductor material, these plastic fastening elements enable the insulation of the printed circuit boards and the electronics from outside. The metal fastening elements, on the other hand, grant a better mechanical strength.



A



B

INCABOX - INCABOX XT

Fastening element

A01000 011 A

Coppia agganci in plastica A / Couple of plastic fastening elements A

A01000 091 A

Coppia agganci in metallo B / Couple of metal fastening elements B

INCABOX - INCABOX XT

The rear frames keep the printed circuit boards in the correct position inside the enclosure. The rear panels are mounted on the rear frames. Thanks to their shape and fixing system, the enclosure may be cut in different lengths according to the customers' requests.

material:
colour:
dimensions:

Self-extinguishing PPO
BLACK
36x72; 72x72; 48x96; 96x96



material:
colour:
dimensions:

Self-extinguishing Nylon 6.6
BLACK
72x144; 144x144; 48x48

INCABOX - INCABOX XT

Rear frames

CODICE / CODE	DESCRIZIONE / DESCRIPTION	SERIE/SERIES
P01240 201C	Cornice posteriore 36.72 / Rear frame 36.72	INCABOX / INCABOX XT
P01440 201C	Cornice posteriore 72.72 / Rear frame 72.72	INCABOX / INCABOX XT
P01460 211C	Cornice posteriore 72.144 / Rear frame 72.144	INCABOX
P01660 201C	Cornice posteriore 144.144 / Rear frame 144.144	INCABOX PLUS
P01330 211C	Cornice posteriore 48.48 / Rear frame 48.48	INCABOX / INCABOX XT
P01350 201C	Cornice posteriore 48.96 / Rear frame 48.96	INCABOX / INCABOX XT
P01550 201C	Cornice posteriore 96.96 / Rear frame 96.96	INCABOX / INCABOX XT
06.275 0001	Pannello posteriore, PPO UL 94 V-O, nero con cornice integrata/ Rear panel, PPO UL 94 V-O, black with integrated frame	INCABOX / INCABOX XT

INCABOX - INCABOX XT

Aggancio per guida DIN

Con l'utilizzo di questo accessorio è possibile montare un INCABOX su guida DIN. L'accessorio viene avvitato sul pannello posteriore dell'INCABOX.

Using this accessory it will be possible to mount the INCABOX enclosure on DIN rail. It is fixed on the INCABOX rear panel with screws.

INCABOX - INCABOX XT

DIN rail fastening base

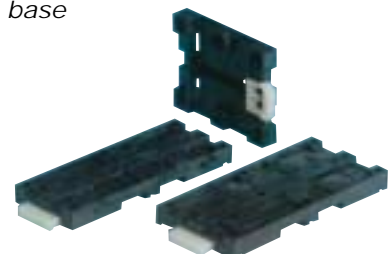

CODICE / CODE	DESCRIZIONE / DESCRIPTION
04.307 N000	Aggancio SDD / SDD base

INCABOX - INCABOX XT

INCABOX - INCABOX XT

Rear panels 8 PIN (OCTAL) and 11 PIN (UNDECAL)



CODICE / CODE	DESCRIZIONE / DESCRIPTION
06.361 000	Pannello OCTAL 36.72 / 8 PIN panel 32.72 (OCTAL)
06.362 000	Pannello OCTAL 48.48 / 8 PIN panel 48.48 (OCTAL)
06.364 000	Pannello OCTAL 48.96 / 8 PIN panel 48.96 (OCTAL)
06.365 000	Pannello OCTAL 72.72 / 8 PIN panel 72.72 (OCTAL)
06.366 000	Pannello UNDECAL 36.72 / 11 PIN rear panel 32.72 (UNDECAL)
06.367 000	Pannello UNDECAL 48.48 / 11 PIN rear panel 48.48 (UNDECAL)
06.368 000	Pannello UNDECAL 48.96 / 11 PIN rear panel 48.96 (UNDECAL)
06.369 000	Pannello UNDECAL 72.72 / 11 PIN rear panel 72.72 (UNDECAL)
P06000001P	Contatto / Pin

The 8 PIN (OCTAL) and 11 PIN (UNDECAL) rear panels allow the INCABOX to be mounted on the 8 or 11 pin sockets. These panels are available only for the INCABOX of smaller dimensions and, in particular for: 36x72, 48x48, 48x96, 72x72. They can be used either for INCABOX or INCABOX XT enclosures.

INCABOX - INCABOX XT

Protection covers

INCABOX - INCABOX XT

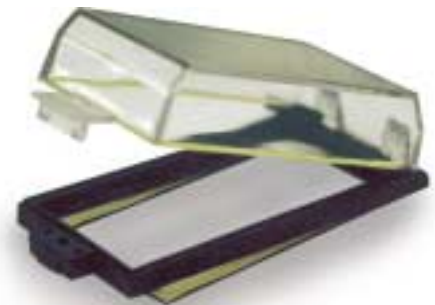

* Protection covers may be supplied upon request with the seal already fitted to have an IP65 protection degree.

CODICE / CODE	DESCRIZIONE / DESCRIPTION	B x H x S
03.432.000	Protezione IP54 per contenitore 48.96 / Protection cover IP54 for enclosure 48.96	56 x 110 x 30.0
03.433.000	Protezione IP54 per contenitore 72.72 / Protection cover IP54 for enclosure 72.72	80 x 87 x 30.0
03.434.000	Protezione IP54 per contenitore 96.96 / Protection cover IP54 for enclosure 96.96	104 x 110 x 30.0
03.435.000	Protezione IP54 per contenitore 72.144 / Protection cover IP54 for enclosure 72.144	80 x 160 x 30.0
03.436.000	Protezione IP54 per contenitore 144.144 / Protection cover IP54 for enclosure 144.144	154 x 158 x 30.0
03.442.000	Protezione IP65 con guarnizione in gomma per contenitore 48.96 / Protection cover IP65 with rubber seal for enclosure 48.96	
03.443.000	Protezione IP65 con guarnizione in gomma per contenitore 72.72 / Protection cover IP65 with rubber seal for enclosure 72.72	
03.444.000	Protezione IP65 con guarnizione in gomma per contenitore 96.96 / Protection cover IP65 with rubber seal for enclosure 96.96	
03.445.000	Protezione IP65 con guarnizione in gomma per contenitore 96.96 / Protection cover IP65 with rubber seal for enclosure 96.96 72.144	
03.446.000	Protezione IP65 con guarnizione in gomma per contenitore 144.144 / Protection cover IP65 with rubber seal for enclosure 144.144	